

Liberty Church Cemetery

Liberty Township
Delaware County Ohio

Copied by
Linda and David Harris
Judi Hill and Jenny Stilwell

Fall 1998

Location of the Liberty Church Cemetery is at the corner of Home Road and State Route 315. This is an old cemetery and is being well taken care of.
Rows were read from west to east. Graves were read from north to south.

Row 1		5	Broken marker-top gone.	
1	Loueza SIMMS born Frederick Md. d.Jun.20,1889	age 18y	6	Sunken marker
			7	Esq John CASE (rest sunken)
Row 2		Row 3		
1	RHOADES Joseph A. 1853-1939 Martha A. 1850-1926		1	Ester B. VIGAR 1895-1918
2	Fredrick E. 1884-1893 Charles L. 1887-1904 Sons of J.E.& M.A. SHEETS		2	VIGAR George B. 1849-1914 Marietta P. 1857-1896
2.5A	Charles		3	Earl G. VIGAR 1886-1907
2.5B	Fredrick		4	Isaac BARD d.Jun.6,1876 age 68y --- Martha O. BARD d.Mar.1,1878 age 62y --- William B. BARD d.Feb.29,1880 age 77y
3	Emma C. dau of J.E.& M. SCHIEDTS d.Aug.4,1887 age 11y6m12d		5	Raney MACOMBER Jul.10,1870 Jul.25,1939
4	CHAMBERS Cyrus 1833-1907 Nancy J. 1839-1920 Their sons James E. 1862-1863 Wilson E. 1867-1868		6	John A. MACOMBER Mar.2,1855 Nov.15,1914

Liberty Church Cemetery - Liberty Township - Delaware County Ohio

14	GOODRICH		7	MACOMBER	
	Fred C.	1878-1952		---	
	Alice A.	1890-19		Mary M.	1816-1894

8	(Sandstone - face fallen off)			Naum	1811-1903
	_____mumon PLUMB				
			8	Grace G. CALOVINI	1907-1993
9	(Sandstone - sunken - face off)				
			9	Robert C. McMASTER	
10	Blank marker			May 13, 1913	Jul. 6, 1986
11	Lydia DIXON wife of Alexr' DIXON		10	JAMES	
	d. Nov. 2, 181?	age 43y		Vincent	1920-
				Rosemary	1924-1989
Row 4					
1	BLANEY		11	Alice FRENCH MAXWELL	
	S.C. BLANEY	1848-1915		Nov. 24, 1895	Jun. 13, 1982
	Mary L. his wife	1855-1894	12	Kamphorng NOUT	
				Apr. 1, 1916	Mar. 18, 1982
2	Thos. W. BLANEY	1860-1886			
			13	COVELL	
3	BLANEY			George W.	1914-1984
	---			Ruth V.	1921-
	Carlton C. BLANEY		Row 5		
	d. Jan. 6, 1874	age 63y4m12d			
	---		1	CASE	
	Ametia E. wife of C. BLANEY			Ralph CASE	
	d. Aug. 29, 1891	age 73y2m22d		Mar. 21, 1834	Aug. 11, 1900
	---			Miranda his wife	
	Henry C. BLANEY			Sep. 28, 1838	Jul. 2, 1906
	CO K 121 REG OVI				
	died at Nashville Tenn		2	CASE	
	Jan. 6, 1864	age 18y4m15d		William CASE	age 76y13d
	Nancy H. BLANEY			b. Jan. 16, 1830	d. Jan. 29, 1906
	d. May 1, 1880	age 17y7m20d			
			3	(by tree)	
4	CASE			J. McK WWII eagle marker	
	Almira CASE				
	d. Sep. 29, 1909	age 83y21d	4	(flat on ground)	
	---			Loran E. WH	
	George CASE				
	d. Jan. 29, 1884	age 59y3m17d	5	Little Gracie dau of Minnie E. LOWRY	
				d. Jun. 16, 1883	age 1m7d
5	(fallen)				
	Francis C. son of Cordelia L. THOMAS		6	Minnie E. dau of U. & S. THOMAS	
	d. Nov. 28, 1878	age 18y8m1d		d. Sep. 16, 1871	age ??
6	W.E. MACOMBER				
	CO E 30TH OHIO INF				

7	UARAL THOMAS CO H 115 OHIO INF	13	FINLEY James FINLEY d.Aug.19,1871	age 61y9m12d
8	Janna A. dau of U.& S. THOMAS d.Jul.4,1881		age 19y6m	
9	THOMAS Uaral THOMAS Dec.25,1830	May 2,1908	Margareta d.Dec.22,1893	age 57y6m24d
	Susannah wife Feb.20,1837	Feb.20,1923	Martha wife of James FINLEY d.Jan.9,1845	age 38y1m
Row 6				
1	Emory M. CRAWFORD 1855-1923		Jane d.Aug.5,1838	age 8m25d
2.5	Joseph Paul BUZAS Jr. Oct.9,1942	Dec.8,1989	John d.Aug.25,1842	age 6m2d
3.5	Ralph A. HEWITT Jr. Jun.4,1941	Mar.11,1983	Infant son d.Oct.10,1843	age 13d
4	Eddie F. CRAWFORD 1885-1913	14	Elizabeth A. d.Mar.13,1867	age 24y5m24d
5	Mary CASE b.Mar.21,1834	d.Apr.14,1899	Calvin F. d.Jan.23,1867	age 31y7m12d
6	Gustavus ELSBREE d.Jun.29,1877	age 49y11m5d	Children of James & Martha FINLEY	
7	Ann dau of E.M.& M.?. CRAWFORD d.Aug.23,1887	age 1y7m4d	Row 7	
8	Base only		1	Base only
9	Emily CASE b.Sep.7,1828	d.Feb.10,1897	2	Rollin N. EVANS 1877-1944
10	(broken) Cynthia wife of A.B. HARD d.Sep.14,1868	age 45y11m10d	3	Melissa J. 1837-1910 wife of Thomas J. EVANS
11	(flat on ground) Mary wife of Ralph CASE d.Feb.28,1835	age 30y8m	4	Lulu W. EVANS 1875-1969
12	Ralph CASE d.Jan.17,1863	age 78y6m11d	5	W.Z. MERCER CO K 145TH OHIO INF
			6	Naioma 1853-1906 wife of I.N. HOWARD
			7	Harriet dau of J.S.& R. EVANS d.Mar.11,1851 (child)

16 Liberty Church Cemetery - Liberty Township - Delaware County Ohio

8	Broken - top missing age 61y1m14d	8	Sarah Ann wife of Geo CHAPMAN dau of James DEDRICK Born in Green Co NY 1816 Died at Utica Ohio Feb.1,1843
9	(flat on ground) Thick marker face down	9	Base only
10	(off base leaning) William EVANS d.Apr.19,1876 age 31/51y3m19d	10	Loraney OSBORN wife of William DEDRICK d.Jan.25,1850 age 62y
11	Gabriel EVANS d.Nov.27,1869 age 76y11m11d	11	Lorene dau of _____ d.Feb.11,1860 age 14y
12	(flat on ground) Mary EVANS d.May 8,1875 age 70y11m25d	12	Abram DEDRICK d.Jun.14,1850 age 30y3m
13	Mary E. wife of W.G. LUKE d.Oct.14,1883 age 23y11m10d	13	(top broken off)
14	Thomas J. EVANS d.Feb.28,1886 age 61y6m12d	14	Lavina A. dau of J.& H. CUMMINS d.Apr.21,1862 age 21y
Row 8		15	(flat on ground) Caroline dau of John & Harriet CUMMINS d.Dec.24,1851 age 17y4m1d
1	Laura F. dau of A.& M.CASE d.Nov.14,1853	16	Ermin A. wife of J. EVANS dau of J.& H. CUMMINS d.Aug.20,1851 age 21y3m4d
2	Cornelia F. dau of A.& M.A. CASE d.Sep.15,1855 age 1y10m12d	17	Harriet CUMMINS wife of John CUMMINS d.Jun.29,1850 age 47y4m19d
3	Sarah wife of Albert CASE d.Dec.31,1865 age 30y8m16d	18	John CUMMINS d.Oct.13,1863 age 65y9m18d
4	Mary A. wife of Albert CASE d.Nov.23,1861 age 28y9m11d	19	(flat on ground) Orson N. CUMMINS d.Mar.27,1866 age 23y10m5d
5	Albert CASE d.Apr.17,1889 age 63y17d	20	(flat on ground) Rachel wife of John S. EVANS d.Mar.9,1860 age 27y11m19d
6	(flat on ground) James B. DEDRICK (rest broken out)	21	Julia A. dau of C.C.& S.L. WATSON d.May 28,1854 age 4y9m17d
7	Hannah wife of J.B. DEDRICK d.Aug.30,1833 age 51y11m		

22	John CUMMINS b.Nov.20,1836	d.Dec.27,1897	8.5	Marian Kirkpatrick Pennell CUNNINGHAM Oct.1838	Sep.1925
23	Ester		9	Robert (child's) (unreadable moss covered)	
24	CASE Franklin	1828-1857	10	Mary S. dau of E.& M. TILTON d.Jul.22,1842	age 1y2m2d
25	Ester A. his wife	1833-1915	11	Eliza C. dau of C.P.& M. ELSBREE d.Jun.7,1862	age 15y11m21d
26	Franklin (flat on ground)		12	Destamona ELSBREE d.Oct.16,1878	age 42y8m
27	Rachel wife of Martin CASE d.Feb.7,1857	age 29y1m14d	13	Collins P. ESBREE d.Feb.16,1880	age 79y10m
Row 9			14	Joseph WILSON d.Aug.7,1834	age 24y7m27d
1	Iris LOWRY BARKER	1899-19	15	Samuel LOURY d.Jan.6,1890	age 70y24d
2	Blanche Edna LOWRY	1903-1978	16	Base only	
3	LOWRY James C.	1868-1938	Row 10		
	Alice J.	1868-1944	1	Hand made foot stone	
4	ANDERSON Lorenzo D.	1837-1911	2	Round foot stone	
	CO I 82 OVVI		3	Susannah TAYLOR wife of Luther CASE d.Nov.25,1875	age 84y
5	Jane M.	1836-1918	4	Susan COLVIN d.Aug.25,1875	age 59y
6	Samuel A. ANDERSON Born in Philadephia Pa Nov.7,1812 d.Mar.25,1871 in his 62nd year		5	(flat on ground - broken) Sylvia wife of Watson CASE (rest hard to read)	
7	Ethel dau of J.C.& A.U. KIRKPATRICK d.Oct.13,1884	age 2m14d	6	(flat on ground - broken) Watson CASE	age 72y2m24d
	Esther wife of R. KIRKPATRICK d.Feb.8,1895	age 89y9m10d	7	b.Jun.8,1781	d. __10, __
	R. KIRKPATRICK d.Feb.28,1881	age 74y9m5d		Blank small foot stone	
	Thomas son of R.& E. KIRKPATRICK d.Dec.21,1854	age 14y1m1d			

18 Liberty Church Cemetery - Liberty Township - Delaware County Ohio

8	Eliza dau of J.& H. LABAREE d.Oct.17,1847 age 25y1m	20	Mary wife of Samuel LOWRY d.Feb.2,1850 age 29y3m16d
9	Blank foot stone	21	(leaning on last marker - top missing) dau of S.& E. LOWRY d.Aug.29,1858 age 1y5m6d
10	Blank foot stone		
11	Seth W. CASE d.May 1,1866 age 54y1m21d Mary T. wife of Seth W. CASE d.Apr.5,1906 age 89y10m5d --- Mary J. d.Jan.16,1853 age 11y22d James B. d.Sep.22,1858 age 13y9m5d Eliza J. d.Aug.30,1866 age 8y9m13d Children of S.W.& M.T. CASE	22	Andrew J. LOWRY b.Jan.14,1822 d.Jan.6,1893 Member of CO K 145TH REG OVI
		23	Wickliff C. MEEKER Nov.2,1835 Nov.28,1884
		Row 11	
12	Ann LOWRY d.Sep.14,1885 age 83y2m5d --- John LOWRY d.Nov.6,1881 age 74y8m8d	1	William A. DIXON 1866-1953
		2	Phebe L. DIXON 1848-1937
		3	James F. DIXON 1872-1916
		4	Bertha E. DIXON 1881-1963
		5	Rebecca DIXON infant 1913
13	Betsey wife of John LOWRY dau of D.& P. THOMAS b.Mar.15,1819 (rest buried)	6	PENNEY Clarence 1884-1961 Grace 1885-1948
14	Infant son of Andrew & Mary LOWRY (no dates)	7	McKINNIE Josiah 1831-1870 Mary J. his wife 1833-1917 Frankie 1863
15	(flat on ground) Margaret & Robert Children of J.& B. LOWRY	8	(broken - leaning on big stone) Franky son of J.& M.S. McKINNIE d.Aug.17,1861 age ?
16	(flat on ground - covered with grass) Mary wife of Orren LOWRY	9	Wm. McKINNIE CO F 96 REG OVI Died at Andersonville Nov.16,1862 age 20y1m20d
17	(flat on ground - broken) Andrew LOWRY d.Oct.26,1836 age 45y	10	James R. son of John & Eliza McKINNIE d.Apr.17,1854 age 21y9m25d
18	Florence dau of C.T.& M.E. LOWRY d.Feb.20,1881 age 1y6m20d		
19	Margaret J. dau of P.& A. THOMAS d.Aug.8,1877 age 26y9m8d		

11	Eliza wife of John McKINNIE d.Feb.23,1882 age 81y10m29d --- John McKINNIE d.Aug.22,1851 age 63y9m27d	Row 12 1	GOODING James Stanley 1859-1930 Esther his wife 1866-1912 Jamie A. 1895-1915 Josephine 1897-1916 Robert K. 1910-1939 Military marker
12	(broken off) Margaret wife of Josiah McKINNIE		
13	Josiah McKINNIE d.Mar.22,1849 age 81y9m24d	2	Marcella DIXON Jun.30,1915 Feb.7,1990
14	In Memory of John McKINNIE who died Oct. 7 AD 1827		(long open space)
15	JOSLIN Lucy JOSLIN d.Feb.14,1886 age 78y5m18d --- Jonas JOSLIN d.Jan.13,1886 age 78y10m19d	3 4	CELLAR Mary W. 1876-1920 John E. 1880-1926 JOHN McKINNIE PVT 3CL 8 CO 4 BN PA MIL Revolutionary War 1741-1827 marker
16	Corey M. dau of H.L.& E.R. GOODRICH d.Sep.25,1865 age 7m25d	5	Broken - off base - unreadable
17	Isabella widow of Jephtha ARRISON d.Sep.25,1841 age 71y	6	Lucy WILSON wife of John F. CELLAR d.Jun.2,1847 age 39y Also three infant children James Hogue d.Jan.20,1843 age 26d Jane Vandeman d.Nov.20,1845 age 9m8d Joseph Axtell (unreadable)
18	Jephtha ARRISON d.Aug.14,1827		
19	Hellen dau of S.R.& Fanny ARRISON d.Aug.28,1842	7	John F. CELLAR d.Oct.7,1875 age 87y7m6d
20	THOMAS Philo THOMAS d.Oct.20,1890 age 70y4m27d Ann his wife 1824-1905	8	Elizabeth DUNLAP CELLAR wife of John F. CELLAR d.Aug.20,1820 age 29y
21	Mary E. dau of L.& ?. SEIGFREID d.May 18,1854 age 1y3m3d	9	CELLAR Sarah WILSON 1839-1902 dau of John F. & Lucy W. CELLAR
22	Mary Ann wife of Wm. SAGER d.Jul.22,1867 age 62y5d	10 11	Samuel Thomas CELLAR d.Oct.25,1865 age 24y9m Joseph DUNLAP d.Jun.26,1820

20 Liberty Church Cemetery - Liberty Township - Delaware County Ohio

12	Broken - face down	9	HARTER	
			Andrew J. HARTER	1836-1905
13	L.E.K.		Lucy Ann wife	1843-1922

14	Lucy E. CELLAR 1837-1902		Ernest HARTER	1881-1882
	wife of Wilson S. KNAPP		---	
	Mary dau of W.S.& L.E. KNAPP		Harry S. HARTER	1869-1888
	age 17y			
	---	10	H.R. CELLAR	1857-1910
	Wilson S. KNAPP			
	d.Mar 20,1885 age 49y	11	Joseph McCoy CELLAR	1830-1902
15	Harlan Page KNAPP	12	Mary C. CELLAR	1868-1884
	Oct.26,1866 May 24,1956			
16	Mila GRISWOLD KNAPP	13	Eliza E. CELLAR	1862-1872
	Jul.6,1874 May 5,1857			
		14	Cynthia SCOTT CELLAR	1833-1871
17	Elizabeth G. KNAPP	15	Margaret Alice dau of J.& E.C. CELLAR	
	Sep.20,1910 Sep.11,1988		d.Sep.28,1846 age 3y10m	
			Sara Frances dau of J.& E.C. CELLAR	
18	Broken - unreadable		d.Sep.26,1841 age 9y8m	
19	William HARDIN d.Nov.14,1863	16	Baruch Halbrook age 5y4m7d	
			son of J.& E.C. CELLAR	
Row 13			b.Sep.27,1832 d.Feb.4,1838	
1	Robert (GOODING)	17	Martha Deademia CELLAR	
			May 3,1848 Jul.9,1897	
2	Josephine (GOODING)	18	E.C.C.	
3	Jamie (GOODING)	19	Joseph CELLAR (his dates on back)	
4	Mother		b.Sep.29,1798 d.Dec.26,1856	
5	Father		Evalyn Cornelia his wife	
			Aug.12,1808 Aug.17,1886	
6	Elizabeth FISHER	20	Sarah FLANAGAN CELLAR	
	d.Sep.3,1844 age 72y		wife of Thomas CELLAR	
	---		d.Jul.18,1823 age 68y	
	Albert H. MERRILL	21	Thomas CELLAR	
	d.Oct.23,1864 age 33y		d.Apr.6,1816 age 75y	
7	Ernest infant son of A.J.& L.A. HARTER	22	Robert McCoy CELLAR	
	b.Jun.7,1881 d.Jan.7,1882		d.Mar.5,1861 age 76y3m9d	
8	Harry S. HARTER	23	Julia P.H. wife of James CELLAR	
			dau of B.& D. HOLBROOK	
			d.Sep.15,1839 age 35y	

24	James CELLAR b.Mar.16,1795	d.Feb.22,1863	9	Father	
25	E.R. CELLAR b.Aug.20,1803	age 70y d.Sep.23,1873	10	Sarah F. GILLES b.Oct.18,1801	d.Jan.3,1884
26	TONE Lafayette TONE Sarah M. his wife Elizabeth D. CELLAR	1824-1908 1834-1915 1834-1915	11	Jane wife of James GILLES d.Oct.9,1844	age 71y4m
27	Elizabeth GOODING d.Jan.12,1865	age 68y2m3d	12	James GILLES d.Jan.14,1844	age 70y7m13d
Row 14			13	John W. son of T.C. & M. GILLES d.Oct.16,1848	age 7y5m
1	TAGGART Lucy KNAPP James E.	1872-1962 1866-1965	14	Thomas C. GILLES d.Jan.6,1879	age 80y11m5d
2	GOODING Fred M. Mary F.	1866-1948 1874-1959	15	Mary dau of James & Jane GILLES d.Dec.19,1822	age 4y
3	HARTER Charles E. Rhoda M.	1865-1946 1872-1946	16	John son of James & Jane GILLES d.Aug.19,1824	age 24y
4	Florence WILSON HARTER	1861-1900	17	Eliza GILLES dau of Jas & Jan GILLES b.Jan.22,1809	d.Oct.5,1839
5	L.P. HARTER		18	Martha M. GILLES dau of Jas & Jane GILLES b.Jan.27,1804	d.Jan.3,1844
6	Laura P. wife of Andrew HARTER d.Jun.5,1866	age 61y3m28d	19	Martha R. dau of John & Hannah CARPENTER d.Sep.29,1823	age 11y9m
---	Andrew HARTER d.May 19,1879	age 81y4m8d	20	____ son of John & Hannah CARPENTER d.Sep.22,1823	age 18y3m18d
---	Elmora dau of A. & J. HARTER d.Apr.20,1880	age 21y9m10d	21	Hannah wife of Jno CARPENTER d.Jun.20,1858	age 77y4m4d
---	Clara E. b.Oct.31,1829	d.Nov.30,1887	22	James Hoge infant son of ?? GILLES (broken off)	
7	E. HARTER		23	Unreadable - all worn off	
8	Solomon HARTER b.Dec.11,1819	d.Feb.22,1891	24	GILLES Jeremiah	1803-1877
---	Christina HARTER HARDIN b.Nov.8,1827	d.Dec.6,1887	---	Emiline	1814-1854

22	Liberty Church Cemetery - Liberty Township - Delaware County Ohio			
25	Ira son of J.& E. GILLES d.Nov.7,1873	10	Rachel CELLAR wife of G. CELLAR d.Feb.12,1887 age 84y	
26	J.J. GILLES CO I 82ND OHIO INF		George CELLAR d.Feb.23,1860 age 69y	
27	Frank R. GILLES 1904-1975		Joseph A. CELLAR CO A 15 REG USA Wounded at Shiloh Tenn Apr.7 died Newport Ky May 11,1862 age 23y	
28	GILLES Georgiana Romeo 1862-1934 1852-1950			
Row 15		11	James H. son of T.& M. CELLAR d.Oct.4,1823 age 7m	
1	TAGGART Eugene K. Helen Y. 1900-1991 1905-	12	(Broken in two pieces) Margaret G. wife of Thomas CELLAR d.Nov.4,1827 age 48y	
2	CORPL GEORGE C. CELLAR CO F 96 OHIO INF	13	Thomas CELLAR d.Jun.11,1854 age 70y4m23d	
3	Eunice A. wife of M.H. CELLAR d.Jan.5,1872 age 38y10m1d	14	(in yucca plant) CAPT JNO CELLAR CO K 145TH OHIO INF	
4	(broken off base) Bessie E. CELLAR d.Dec.24,1896 age 35y	15	Stephen S. EATON d.Aug.28,1845 age 60y	
5	Our daughter Mary	16	Olive wife of Stephen S. EATON d.Sep.30,1879 age 94y	
6	Solomon (CELLAR) Christina (CELLAR)	17	Stephen L. EATON Feb.23,1826 Mary EATON May 29,1830 Mar.10,1878 Oct.18,1884	
7	Sarah A. CELLAR b.Dec.27,1840 d.May 3,1911 --- Robert McCoy CELLAR b.Oct.3,1834 d.Mar.23,1881 --- Eliza C. CELLAR b.Jun.1,1868 d.Feb.26,1893		H.J.E. Mar.24,1849 C.E. Jan.8,1858 May 1,1851 Mar.1,1859	
8	Mary wife of G.C. CELLAR d.Nov.18,1874 age 32y11m4d Infant son of G.C.& M. CELLAR d.1874 Infant dau of G.C.& M. CELLAR d.1868		Charles E. EATON Jun.9,1862 Sep.27,1871	
		18	Mother	
		19	Desdemone COLFLESH d.May 4,1881 age 80y6m	
9	Sarah J. CELLAR 1833-1911			

20	Capt. Joab NORTON d.Jul.17,1813 Lucy G. wife of Capt. Joab NORTON d.Nov.28,1854	age 83y6m5d age 75y1m16d	14	Edith A. dau of T.& R. ANDREWS d.Jun.3,1850	age 24y?m?d
Row 16			15	Albert B. son of C.A.& E. ANDREWS d.Dec.8,1860 Franklin A. son of C.A.& E. ANDREWS (rest unreadable)	age 17y
1	KILPATRICK Elizabeth S. Walter M.	1878-1947 1874-1945	16	Asenath consort of Michael HINKLE d.Jan.25,1844	age 46y
2	Henry RUTHERFORD	1853-1918	17	Matilda wife of J. Q. MACOMBER d.Feb.23,1863	age 36y
3	Mother		18	Philander LATHROP d.Nov.20,1842	age 66y
4	Eliza J. RUTHERFORD Abraham RUTHERFORD b.Apr.7,1830	1830-1908 d.Mar.27,1895	19	Mary Jane dau of John & M. McCULLAUGH d.Jul.6,1837	age 8m21d
5	Father		20	Mary McCULLAUGH d.May 11,1837	age 37y
6	Lucy E. wife of E.B. MARKS Sep.21,1833	Aug.15,1905	21	Margaret M. McCULLAUGH d.Nov.22,1838	age 19y1m19d
7	Florence E. dau of E.B.& L.E. MARKS d.Jul.29,1856	age 2y3m2d	22	R.M. ANDERSON CO I 82ND OHIO INF	
8	Erastus B. MARKS	1825-1909	23	Robert McCOY d.Aug.20,1827	age 50y7m12d
9	Ann KNIGHT wife of Sheldon MARKS d.Jun.9,1879 Sheldon MARKS d.May 14,1879	age 79y4m19d age 86y11m10d	Row 17		
10	William O. son of S.& A. MARKS d.Mar.24,1866	age 2y10m17d	1	WALTER M. KILPATRICK PVT 50 IOWA INF NOV.27,1874	FEB.22,1945
11	Sylvester T. son of Sheldon & Ann MARKS d.Aug.16,1875	age 13y	2	Broken marker	
12	Ruth B. wife of Timothy ANDREWS d.Feb.8,1866 Timothy ANDREWS d.Dec.11,1880	age 65y age 82y	3	Lucy A. wife of D. SHAW and dau of P. V. YOUEL d.Dec.26,1869	age 20y4m29d
13	Lorenda P. wife of S.W. ANDREWS d.Aug.13,1845	age 25y	4	SGT J.P. WEAVER CO 8 82ND OHIO INF	

24 Liberty Church Cemetery - Liberty Township - Delaware County Ohio

		Row 18		
5	Charles H. son of Wm. E. & C.S. BRADLEY b.May.21,1846 d.Jan.13,1849	1	Wm. JAMES d.Mar.15,1875?	age 62y
6	(broken) Ira BRADLEY b.Oct.14,178? d.Nov.25,185?	2	Susan wife of Wm. JAMES d.Mar.25,186?	age 55y
7	L.W.C.	3	? E. son of H. & S.E. GREGG d.Oct.24,1848	age 1y10m
8	SGT ALLEN McCUTCHEN CO O 45TH OHIO INF	4	Small broken stone	
9	James R. YOUEL d.Jun.7,1879 age 62y8m17d	5	Viola E. dau of E. & E. CONWAY d.Sep.5,1869	age 8m25d
10	Ann Eliza dau of John (unreadable)	6	Ebenezer CONWAY d.Jul.22,1845	age 38y9m
11	Nancy wife of John YOUEL d.Aug.31,1844 age 58y	7	John HARDIN d.Jan.26,1851	age 59y7m20d
12	Francis E. son of J.R. & P.V. YOUEL d.Jun.5,1851 age 10m		--- Sarah wife of John HARDIN d.Jan.5,1879	age 97y1m1d
13	James D. son of J.R. & P.V. YOUEL Wounded at Nashville Tenn Dec.16,1864 Died at Jeffersonville Hospital Ind Mar.11,1865 age 17y11m		--- Isaac O. son of J. & S. HARDIN d.Oct.28,1871	age 49y1m28d
14	Nathan CARPENTER 1824-1855 Polly ANDREWS his wife 1829-1893 Natie son 1855-1861 Natives of Worthington O	8	Sary HARDEN consort of Isaac HARDEN d.May 7,1832	age 79y
15	Nathan CARPENTER d.Mar.14,1855 age 30y11m	9	Isaac HARDEN d.Apr.11,1827	age 79y
16	W.T.H.	10	Edmund P. son of Issac & Catherine HARDEN d.Aug.6,1843	age 26y
17	Nancy dau of John & M. McCULLOUGH d.Mar.19,1836 age 7m9d	11	Small stone	
18	Nancy wife of James FLANEGIN d.Nov.20,1820 age 38y	12	Small stone	
19	R. McC.			

Row 19

1	Mary C. GRAY	1859-1940	---	Roxy wife of Major b.Dec.13,1812	d.Sep.1,1892
2	GRAY		13	? BARTHOMEW d.Sep.10,1848	age 3y7m4d
3	John P. GRAY	1853-1912			
4	W.A. GRAY	1836-1911	14	Jasper son of M.& R. BARTHOLOMEW d.Feb.1,1871	age 23y9m5d
5	W.J.			---	
6	G.C.			Thomas C. son of M.& R. BARTHOLOMEW d.Sep.10,1848	age 3y7m11d
7	G.H. CRUIKSHANK Apr.4,1821	Jan.10,1902	15	Emily J. CASE wife of M.S. CASE d.Apr.9,1873	age 36y7m7d

	Agusta F. wife of G.H. CRUIKSHANK May 27,1822	Dec.25,1899	16	Benjamin BARTHOLOMEW d.Jul.11,1857	age 81y

	Martha E. dau of G.H.& A.F. CRUIKSHANK d.Apr.9,1875	age 14y4m7d	17	Lydia L. dau of P.E.& Lucy A. BUELL d.Oct.20,1819	age 22y1m19d

	In memory of G.H.& A.F. CRUIKSHANK'S children Harriet J. d.Mar.19,1854	age 2y10m11d	18	Lucy A. wife of P.E. BUELL d.Aug.16,1854	age 51y11?m21d
	Geo. T. d.Oct.4,1855	age 11m	19	Philaster E. BUELL d.Jan.15,1886	age 83y4m8d
	Freddie d.Aug.27,1856	age 17d	20	William CRUIKSHANK Jun.2,1816	Jan.15,1904
	Peter d.Sep.23,1862	age 2m		---	
	Dora d.Jul.8,1866	age 5m11d		Cynthia M. wife of Wm. CRUIKSHANK b.Nov.30,1818	d.Nov.12,1891
8	Mother (Cruikshank)			Elizabeth M. b.Dec.17,1844	d.Mar.12,1849
9	Father (Cruikshank)			Edward P. b.Feb.8,1840	d.Sep.18,1853
10	Small stone			---	
11	Grandmother			George W. CRUIKSHANK CO I 14 ? REG OVI b.Nov.19,1842	d.Jan.1865
12	BARTHOLOMEW Major d.Oct.29,1871	age 67y10m16d		---	
				Eugene D. b.Oct.25,1846	d.Nov.12,1863
				Homer D. b.May 12,1841	d.May 13,1864

26	Liberty Church Cemetery - Liberty Township - Delaware County Ohio		
21	Mother	4	Mary wife of J.B. DUTCHER d.Jul.7,1882 age 78y7m23d
22	Elizabeth		
23	Edward	5	John B. DUTCHER d.Oct.13,1867 age 65y11m26d
24	Eugene	6	Broken stone
25	Homer	7	David L. son of John B. & Mary DUTCHER d.Jun.4,1850 age 22y7m14d
26	S.W. KNAPP b.Jun.19,1794 d.Nov.26,1859		
27	Mary H. wife of S.W. KNAPP b.Sep.10,1802 d.Jul.9,1888	8	(Broken stone) Murice son of J.A.& Emily M.D. SIM d.Aug.9,1885 age 3y7m21d
	Marlan P. KNAPP b.Mar.27,1839 d.Oct.19,1861	9	(Broken stone) Infant dau of Wm. J.& E.D. DUTCHER b.Oct.28,1861 d.Nov.29,1861
	Harriet B. b.Jul.2,1845 d.Oct.27,1861		
	Children of S.W.& M.H. KNAPP	10	Broken stone
28	S.W.K.	11	Broken stone
29	LIEUT. H.J. JARVIS CO G 96TH OHIO INF	12	(Broken stone) Elizabeth dau of G.A.& E. GOODING d.Oct.22,1855 age 11m22d
Row 20			
1	Small stone	13	Jacob L. son of J.& E. COLFLESH d.Dec.18,1847 age 17y10m26d
2	(Broken stone) Loren J. son of D.G.& E. CRUIKSHANK d.Sep.16,1858 age 10m?d	14	Betsy wife of James COLFLESH d.Jun.1,1876 age 58y1m16d
3	David G. CRUIKSHANK d.Jun.8,1869 age 60y9m14d	15	Jacob COLFLESH b.Jan.23,1787 in the state of Penn. Emigrated to Ohio in 1837 d.Aug.9,1877 age 90y7m
	--- Eliza CRUIKSHANK 1816-1891		
	--- Loren J. CRUIKSHANK d.Sep.16,1858 age 10m22d	16	Elect Ann age 31y dau of Baruck & Deadamia HOLBROOK b.Dec.6,1810 d.Mar.23,1841
	--- ERVIN P. CRUIKSHANK CO F 96 REG OVI Killed in action at Sabine Crossroads La Apr.8,1864 age 23y7m10d	17	Elizabeth Eunice age 41y consort of Joseph HYDE & dau of B.& D. HOLBROOK b.Apr.16,1800 d.Jun.5,1840

18	Azel Hart son of Baruck & Deadamia (Holbrook) b.Apr.4,1806	age 33y d.Sep.17,1839	11	Small stone	
19	Addison Dwight son of Baruck & Deadamia HOLBROOK b.Mar.3,1815	age 24y d.Feb.7,1839	12	TAGGART Margaret wife of John TAGGART d.Feb.20,1880 John TAGGART d.Oct.30,1869	age 66y2m18d age 57y6m2d
20	Joseph Moyer son of Baruck & Deadamia HOLBROOK b.Sep.28,1820	age 19y d.Jul.13,1840	13	E.G. TAGGART Mary B. his wife	1836-1907 1833-1917
21	Deadamia DUGUID consort of Baruck HOLBROOK b.Feb.19,1778	age 62y d.Sep.29,1840	14	Geo. A. GOODING Nov.4,1826 Elizabeth his wife Dec.17,1828	Mar.19,1900 Dec.1,1910
22	Baruck HOLBROOK b.Feb.11,1769	age 72y d.Jul.27,1841	15	(Broken stone) _____ son of J.& E. COLFLESH d.Aug.19,1855	age 12y6m13d
23	Lucretia YOKAM dau of J.& H. HYDE d.Jan.26,1870	age 27y5m	16	(Broken stone) Luella dau of J.C.& E. COLFLESH d.Feb.3,1864	age 3y1m13d
24	Joseph HYDE d.Aug.12,1873 Civil War marker	age 81y11m13?d	17	M.M.B.	
Row 21			18	Broken stone	
1	CRUIKSHANK		19	Broken stone - unable to read	
2	Mary CRUIKSHANK nee WOODLAND		20	Small stone	
3	Stephen L. CRUIKSHANK 1835-1909		21	Thomas son of Elias & Nancy SLAIN d.Sep.11,1846	age 18y5m18d
4	Frank L. CRUIKSHANK 1859-1895		22	Nancy wife of Elias SLAIN d.Jun.18,1840	age 54y
5	Irvin P. CRUIKSHANK 1862-1864		Row 22		
6	Charles J. CRUIKSHANK 1857-1864		1	W.S.K.	
7	May CRUIKSHANK d.1879	age 23d	2	M.T.	
8	Small stone		3	J.T.	
9	Small stone		4	Small stone	
10	Small stone		5	E.S. GRAY CO K 145TH OHIO INF	

6	GRAY John P. GRAY Aug. 19, 1811 Eliza his wife Jul. 17, 1815 --- Ebenezer S. Oliver T. Clarissa E. Phoebe J. Margaret E.	Sep. 25, 1867 Oct. 13, 1897 1840-1864 1843-1863 1846-1867 1848-1867 1851-1896	17	Miles S. CASE Broken stone Unable to read	1832-1912
7	Mother		20	E.O. HARDEN son of R. & E. HARDEN d. Jul. 5, 1881 GAR marker	age 31y6m20d
8	B.F. SMITH d. Feb. 22, 1860 --- Amanda wife of B.F. SMITH d. Jan. 2, 1894	age 50y5m12d age 81y2m1d	Row 23		
9	Martha E. wife of A.D. TULLER & dau of B.F. & A. SMITH d. Jan. 17, 1869	age 23y9m20d	1	Broken stone	
10	Sara J. d. Jun. 20, 1900 Josephine A. d. Aug. 14, 1880 daus of B.F. & A. SMITH	age 59y9m27d age 29y4m28d	2	Mary CARPENTER Sarah CARPENTER BROWN	1824-1900 1833-1901
11	D.S. THOMPSON CO E 175TH OHIO INF		3	SLACK Laura P. wife of Gilbert SLACK d. Jan. 29, 1892 --- L.P. SLACK --- Gilbert SLACK	age 36y4m28d 1886-1941 1851-1916
12	Phebe dau of C. & A. BRISTOL d. Aug. 26, 1868	age 9y5d	4	Broken stone	
13	Annah wife of Correl BRISTOL d. Jan. 14, 1870	age 54y	5	Wife and Children of W.F. HARDIN Elizabeth J. HARDIN b. Nov. 20, 1857 Lewis E. HARDIN b. Aug. 28, 1881 William T. HARDIN b. Dec. 2, 1882	d. Sep. 22, 1895 d. Apr. 25, 1883 d. May 18, 1883
14	ELSBREE George Francis Sep. 11, 1834 Caroline CASE his wife Aug. 12, 1837	May 28, 1919 May 15, 1918	6.5	ELSBREE	
15	Titus CASE d. Jan. 31, 1860	age 63y	7.5	A.C. ELSBREE Elizabeth A.	1831-1920 1830-1900
16	Hannah M. wife of Titus CASE d. Aug. 15, 1895	age 96y7m3d	8.5	E.A.E.	
			Row 24		
			1	Broken stone	
			2	Allen CASE Mar. 10, 1855	Sep. 28, 1932

3	Hillie GOODRICH wife of Allen CASE d.Oct.28,1928	13	Base
4	GOODRICH Lawrence F. 1852-1920 Emma F. 1857-1947	14	Rachael wife of Joseph HYDE d.Jan.17,1853 age 36y
5	Broken stone	15	James B. son of S.W.& Mary CASE d.Sep.22,1858 age 3y9m5d
6	J.B.C.	16	Samuel McCUTCHEN d.Dec.26,1850 age 14y7m12d
7	M.J. CLOSSON mother Jul.21,1845 Jun.27,1903	17	T.C.C.
The following tombstone were piled against the Church		18	Broken - unreadable Several bases in a pile

- 1 (top broken)
Nathan E. son of G.& E. GILLES
d.Apr.11,1836 age 1m3d
- 2 Little Franky
- 3 Mary Jane dau of S.W.& Mary CASE
d.Jan.16,1853 age 14y22d
- 4 G.P.I.
- 5 (top broken)
wife of A.L. KIMBER
d.Oct.29,1849 age 21y1m18d
- 6 (flat on ground)
Garrett EVERETT
d.Sep.23,1857 age 17y6m22d
- 7 (broken in 3 pieces - blank)
- 8 Emeline wife of J. GILLES
d. __24,1854 (broken)
- 9 Broken - unreadable
- 10 Ann Eliza wife of Erastus HARDEN
d.Mar.1,1854 age 25y4m7d
- 11 Sandstone unreadable
- 12 Isaac D. (unreadable)

CHURCH

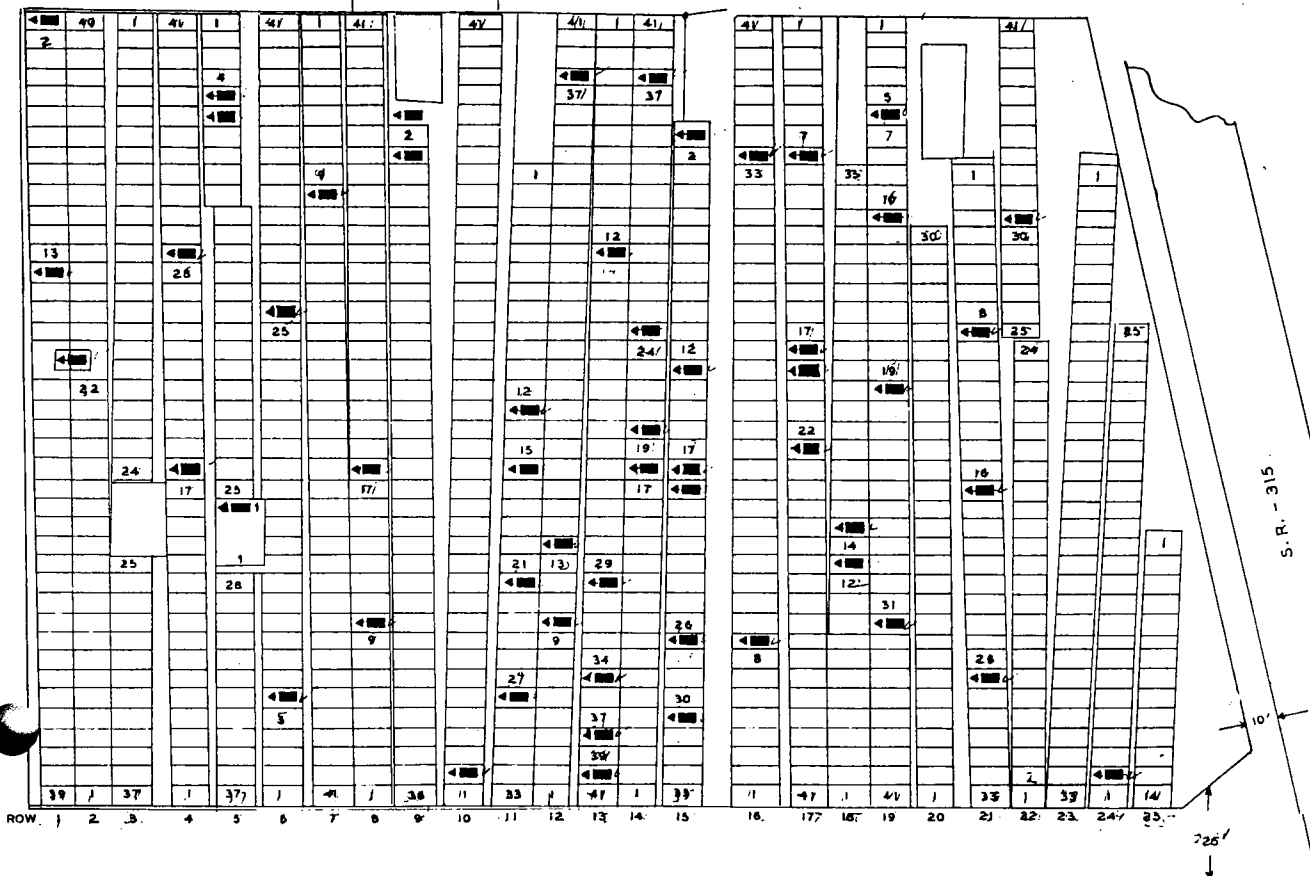

C - 124

NAME	L	R	G	W
ANDERSON LORENZO D.	9	1	19	
ANDERSON R. ANDERSON	16	9	19	
ANDERSON SAMUEL D.	9	3	19	
BARTHOLOMEW BENJ.	19	20	10	
BLANEY HENRY C.	4	29	19	
CASE RALPH	6	26	10	
CASE RALPH	5	5	19	
CASE WM.	5	6	19	
CELLAR E. R.	13	35		
CELLAR GEO.	15	18	10	
CELLAR GEO. C.	15	1	19	
CELLAR JOHN F.	12	14	10	
CELLAR JOHN	15	31	19	
CELLAR JOS. A.	15	19	19	
CELLAR ROBT. MACOY	13	30	10	
CELLAR ROBT. M.	15	13	19	
CELLAR THOS. MACOY	15	27	10	
CHAMBERS CYRUS	2	23	19	
CRUIKSHANK ERVIN B.	19	11	19	
CRUIKSHANK GEO. W.	19	32	19	
CUMMINS JOHN F.	6	10	19	
CUMMINS ORSON N.	6	18	19	
ELSBREE A. C.	24	2	19	
ELSBREE GEO. F.	21	9	19	
EVANS G. M.	6	6		
GILLIES JAMES	14	20	10	
GILLIES JOS. J.	14	38	19	
GRAY EBENEZER S.	21	27	19	
GRAY OLIVER	22	31	19	
GRAY WM. A.	19	6	19	
HARDIN ISAAC	18	13	1	
HARDIN JOHN	18	15	10	
HARTER ANDREW J.	13	15	19	
KNAPP WILSON S.	12	38	19	
LOWRY ANDREW J.	10	2	19	
MACOMBER W. E.	4	18		
MARKS ERASTUS B.	16	34	19	
MERCER W. C.	7	10	19	
MERRILL ALBERT H.	12	10	19	
MSCUTCHEN ALLEN	17	18	19	
MUNN J. JOHN	11	22	1	
MUNN J. JOSIAH	11	22	10	
MUNN J. JOSIAH	11	13	19	
MUNN J. WM.	11	16	19	
NORTON CAPT. JOAB	13	40	10	
STANDISH WILLARD			19	
THOMAS JOHN H.	1	14	19	
THOMAS MARAL	5	1	19	
THOMAS PHILO	11	28	19	
THOMPSON D. S.	21	17	19	
TONE LAFAYETTE	13	38	19	
WEAVER JONAS P.	17	8	19	
YUCEL JAMES D.	17	23	19	
YUCEL JAMES R.	17	19		

LEGEND
L=LOT R=ROW
G=GRAVE W=WAR
X=POSITION UNKNOWN

LIBERTY CEMETERY

DELAWARE CO. LIBERTY TWP.

OFFICIAL PROJECT NOS. 485-42-3-467 AND 665-42-3-232

LEGEND

- ① REVOLUTIONARY WAR
- ② WAR OF 1812
- ③ MEXICAN WAR
- ④ CIVIL WAR
- ⑤ SPANISH AM. WAR
- ⑥ WORLD WAR

SCALE 1"=20'

ACRES 1.00

21-9-2

© 2006 - 2010 Leona L. Gustafson

#10

Liberty Church Cemetery
(AKA Old Liberty Cemetery)
Liberty Township, Delaware County, Ohio



Gravestone Photographs

This small cemetery is located at 7080 Olentangy River Road (northeast corner of Olentangy River Road and Home Road) in Liberty Township. Liberty Presbyterian church has been in continuous service to the community since about the time of the War of 1812. Read how the church "began with a love story" at <http://www.libertybarnchurch.com/history.html>. It will probably require a few more trips to the cemetery before we finish a complete photographic inventory.

If you would like to have us take photos of any of the gravestones in this cemetery, or if you have photos taken at this cemetery and would like to share them, please, write to me at [Leona L. Gustafson](mailto:Leona.L.Gustafson).

GPS Coordinates:

DEC - Latitude = 40.1942290 Longitude = -83.0535194

DMS - Latitude = 401139N Longitude = 0830313W

[MAP](#)

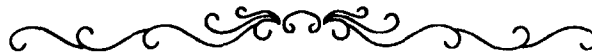

Gravestones: [A](#) | [B](#) | [C](#) | [D](#) | [E](#) | [F](#) | [G](#) | [H](#) | [I](#) | [J](#) | [K](#) | [L](#) | [M](#) | [N](#) | [O](#) | [P](#) | [Q](#) | [R](#) | [S](#) | [T](#) | [U](#) | [V](#) | [W](#) | [X](#) | [Y](#) | [Z](#) |
[Unknown](#)

(Click on the underlined name to download the gravestone photograph)

Note: Items enclosed by brackets ([]) are the Webmaster's "best guess," or came from outside sources, most notably Delaware County Burials.

Items underlined in black are uncertain.

- **Anderson**
 - Lorenzo D., 1837-1911, CO 82 OVVI, and Jane M., 1836-1916 (Whole stone)
 - Samuel A., born in Philadelphia, Nov 7, 1812, died March 25, 1874, in his 62 year (Whole stone)
- **Barker, Iris Lowry, 1899-1999**
- **Blanchard, Amos, died Sept 6, 18[55], aged 37? yrs 9 mo (High resolution detail)**
- **Blaney**
 - Our Father and Mother - Carlton C., died Jan 6, 1874, aged 63y 4m 12d and Amelia E., wife of C, died Aug 29, 1891, aged 73y2m22d
 - S. C., 1848-1915 and Mary L., his wife, 1855-1894
 - Samuel C., Blaney, died 16 Apr 1915 (Ohio Death Certificate, Delaware County No. 21446)
 - Thomas W., 1880-1886
- **Bristol**
 - Annah, wife of Correl, died Jan 14, 187[0], Aged 54 yrs
 - Phebe, dau of C & A, died Aug 25, 1869, aged 9 ys 5 ds (Whole stone)
- **Brown, Sarah Carpenter (see Carpenter)**
- **Burger, Betsy Ann, died Mar 26, 1861, aged 70 (50?) yrs**
- **Buzas, Joseph Paul, Jr., Oct 9, 1942-Dec 8, 1989**
- **Calovini, Grace G., 1907-1993**
- **Carpenter, Mary, 1824-1900 and Sarah Carpenter Brown, 1833-1901**
- **Case**
 - Albert, died Apr 17, 1889, aged 63y & 17d (Whole stone)
 - Allen, Mar 10, 1855-Sept 28, 1932
 - Emily, Sept 7, 1829-Feb 10, 1897
 - Franklin, 1828-1857 and Esther A., his wife, 1883-1915
 - Hannah M., wife of Titus, died Aug 15, 1895, aged 96 ys 7 ms 3 ds
 - Hillie R. Goodrich, wife of Allen, died Oct 23, 1928
 - James B., son of S W & Mary, died Sept 22, 1858, aged 3 ys 9 mo 5 ds
 - Mary, Mar 21, 1834-Apr 14, 1899 (Whole stone)
 - Mary A., wife of Albert, died Nov 23, 1861, aged 28 yrs 9 mos & 11 ds (Whole stone)
 - Mary Jane, dau of S W & Mary, died Jan 16, 1853, aged 11 ys 23 ds (Whole stone)
 - Miles S., 1832-1913
 - Norman, died Jan 29, 1884, aged 59y 3m 7d, and Almira, died Sep 29, 1909, aged 83y 21d (Whole stone)
 - Rachel, wife of Martin, died Feb 14, 1866, aged 80 yrs ?? mos ?? ds
 - Ralph, died Jan 17, 1863, aged 78 yrs 6 mo 11d (Whole stone)
 - Ralph, Mar 31, 1834-Aug 11, 1900 and Miranda, his wife, Sept 28, 1838-July 2, 1905 (Whole stone)
 - Sarah, wife of Albert, died Dec 31, 1865, aged 30 yrs 8 mos & 16ds (Whole stone)
 - Serg, Seth, Connecticut State Troops, Rev War, Sep 29, 1749-Jun 4, 1813
 - Seth W., died May 1866, aged 54 yrs 1 mo 21 ds and Mary T., wife of Seth W., died Apr 5, 1906, aged 89 ys 10 ms 5 ds (Whole stone)
 - Susannah Taylor, wife of Luther, died Nov 25, 1875, aged 81 yrs (Whole stone)
 - Sylvia, wife of Watson, [27 Jul 1780-18 Jul 1855]
 - Titus, died Jan 31, 1860, aged 63 yrs (High resolution)
 - Watson, born June 8, 1781-[broken]
 - William, Jan 16, 1830-Jan 29, 1906, aged 76 yrs 13 ds
- **Chambers, Cyrus, 1833-1907; Nancy J., 1839-1920; their sons, James E., 1862-1863 and Wilson E., 1867-1868**
- **Chapman, Sarah Ann, wife of Geo. and daughter of Jamed Dedrick, born in Green---, N Y, 1816, died at U---, Ohio, Feb 1, 1843**
- **Chasteen, Rosalie Camille Calovini, Dec 5, 1939-June 15, 2001**
- **Colflesh**
 - Broken, died June 13, 1866, aged 53 yrs 10 mos & 5 ds
 - Betsy, wife of James, died June 1, 1876, aged 58 yrs 1 mo & 16 ds (Whole stone)
 - Jacob, born Jan 23, 1787 in the state of Penn., emigrated to Ohio in 1837, died Aug 9, 1877, aged 90 ys & 7 ms (Whole stone)
 - Joseph L., son of J & E, died Dec 18, 1847, aged 17 yrs 11 mos 26 ds
 - Lu Ella, dau of J C & E, died Feb 3, 1864, aged 3 yrs 1 mo 13 ds

- **Colvin, Susan**, died Aug 25, 1875, aged 39 years
- **Covell, George**, 1914-1928 and **Ruth V.**, 1921-[blank]
- **Crawford**
 - **Eddie F.**, 1885-1913
 - **Emory M.**, 1855-1923
- **Cruikshank**
 - **Plot monument**
Listed in the order photographed
 - **May**, 1879, aged 23d
 - **Charles J.**, 1857-1864
 - **Irvin P.**, 1862-1864
 - **Frank L.**, 1859-1895
 - **Stephen L.**, 1835-1909
 - **Mary**, nee-Woodland [1834-1910]
 - **Eliza**, 1816-1891; **David G.**, died June 8, 1869, aged 60 yrs 9 mo 11 ds; **Loren J.**, died Sept 16, 1858, aged 10 mo 22 ds, and **Ervin R.**, CO F, 96 REG OVI, Killed in action Sabine Crossroads, La., Apr 8, 1864, aged 23 yrs 7 mo & 10 ds (Whole stone and **Loren J.**--original stone)
- **Cummings**, **Harriet**, wife of **John**, died June 29, 1850, aged 47 years 4 mos & 19 days (See also **Cummins**)
- **Cummins** (See also **Cummings**)
 - **Caroline**, daughter of **John & Harriett**, died Dec 24, 1851, aged 17 yrs 3 m & 1 day
 - **John**, died Oct 13, 1863, aged 65 yrs 9 mos & 18 ds
 - **John F.**, Nov 20, 1836-Dec 27, 1897
 - **Lavina A.**, daugh of **J & H**, died April 21, 1862, aged 21 yrs (Whole stone)
- **Cunningham**, **Maria Kirkpatrick Pennell**, Oct 1838-Sept 1925
- **Dedrick**
 - **Abram**, died June 14, 1850, aged 30 yrs 3 mos
 - **Hannah**, wife of **J B**, died Aug 30, 1833, aged 51 ys 11 mo
 - **Loraney Osborn**, wife of **William**, died Jan 25, 1850, aged 62 ys
- **Dixon**, **Mrs. Lydia**, wife of **Alexr.** [broken & buried]
- **Ducher**, **David L.**, son of **John B. & Mary**, died June 4, 1850, aged 22 ys 7 mo & 14 ds
- **Dutcher**
 - **Infant dau** of **Wm J & E D**, Oct 28, 1861-Nov 29, 1861
 - **John B.**, died Oct 13, 18[67], aged 65 ys 11 mo ?? ds
 - **Mary**, wife of **John B.**, [14 Nov 1804-7 Jul 1883]
- **Elsbree**
 - **A. C.**, 1831-1920 and **Elizabeth A.**, his wife, 1836-1901
 - **Collins P.**, died Feb 16, 1880, aged 79 yrs 10 m (Whole stone)
 - **Destamona**, died Oct 16, 1878, aged 42 yrs 8 mo (Whole stone)
 - **Eliza C.**, dau of **C P & M**, died June [7], 1862, aged 15 yrs ? m [21 ds]
 - **George Francis**, Sept 11, 1834-May 28, 1919 and **Caroline Case**, his wife, Aug 12, 1837-May 15, 1918
 - **Gustavus**, died June 29, 1877, aged 49y 11m 5d (Whole stone)
- **Evans**
 - **Ermina**, wife of **Thomas J** and daughter of **J & M Cummings**, died Aug 20, 1851, aged 21 yrs 3 mos & 4 days (Whole stone)
 - **LIEUT. G. M.**, CO A, 62ND ILL INF
 - **Gabriel**, Dec 16, 1792-Nov 27, 1869
 - **Lulu W.**, 1875-1969
 - **Mary**, died May 8, 1875, aged 70 yrs 11 ms & 25 ds
 - **Mother**, **Melissa J.**, wife of **Thomas J**, 1837-1910
 - **Rollin N.**, 1877-1944
 - **Sally M.**, wife of **Wm**, died Nov 20, 1861, aged 37 yrs 6 mo & 11 ds
 - **Thomas J.**, died Feb 28, 1886, aged 61 y 6 m 12 d
 - **William**, died Apr [18, 1876] (Whole stone)
- **Everett**
 - **Garrett**, died Sept 23, 1857, aged 47 ys 6 mo 28 ds
 - **John**, died July 26, 1857, aged 23 ys 11 mo 28 ds
 - **Susannah**, wife of **G P**, dau of **C & L Elsbree**, died Oc3, 18__

- **Gillis**
 - Emeline, wife of J, died ??? 21, 1854 [Possibly broken upper portion of Nathan's stone]
 - Nathan E., son of J & E, died Sept 11, 1836, aged 1m 7d ([High resolution 132KB](#)) [Possibly broken lower portion of Emeline's stone]
- **Gooding**
 - Elizabeth, dau of G A & E, died Oct 26, 1855, aged 11 mo 22 ds
 - Geo. A., Nov 4, 1826-May 19, 1900 and Elizabeth, his wife, Dec 17, 1823-Dec 1, 1910
- **Goodrich**
 - Fred C., 1878-1952 and Alice A., 1890-19[blank]
 - Lawrence F., 1852-1920 and Emma F., 1857-1947
- **Gray**
 - E. S., CO K, 145TH OHIO INF (probably Ebenezer S. below)
 - John P., Aug 19, 1811-Sept 25, 1867 and Elizabeth his wife, July 17, 1815-Oct 13, 1897; and on back Ebenezer S., 1840-1864; Oliver T., 1843-1863; Clarrisa E., 1846-1867; Phoebe J., 1848-1967; and Margaret E., 1851-1896
- **Hard**, Cynthia, wife of A Z, died Sept 14, 1868, aged ??y ??m 10 ds
- **Harden**
 - Ann Eliza, wife of Erastus, died Mar 1, 1854, aged 25 ys 4 mo 7 ds
 - E. O., son of R & E, died July 5, 1881, aged 31y 6m 20d ([Whole stone](#))
Edmond O., son of Reuben and Elizabeth
- **Hardin**, Elizabeth, Nov 20, 1857-Sept 12, 1895; Lewis E., Aug 28, 1881-Apr 25, 1883; William T., Dec 2, 1882-May 16, 1883, wife and children of W F ([High resolution 112KB](#))
- **Heller**, Christena, died Oct 13, 1862, aged 47 yrs
- **Hewitt**, Ralph A., Jr., 4 June 1941-11 March 1983
- **Holbrook**
 - Listed in order taken
 - Addison Dwight, son of Baruch & Deadamia, Mar 3, 1815-Feb 7, 1839, aged 24 years ([Whole stone](#))
 - Joseph Moyer, son of Baruch & Deadamia, Sept 28, 1820-July 15, 1840, aged 19 years
 - Deadamia Duguid, consort of Baruch, Feb 13, 1778-Sept 29, 1840, aged 62 years
 - Baruch, Feb 11th, 1769-July 27th, 1841, aged 72 years
- **Howard**, Naioma, wife of ? N, 1853-1906
- **Hyde**
 - Elizabeth Eunice, consort of Joseph, daughter of [B] & [D], Holbrook, born April 16, 1800, died June 5, 1840 in her 41st year ([Whole stone](#))
 - Joseph, April 12, 1873, aged 84 yrs 11 mo 15 ds ([Whole stone](#))
 - Lucretia Yo[kam], dau of [J] & H, died Jan 26, 18[70], aged ?? yrs 5 mos ([Whole stone](#))
 - Rachel, wife of Joseph, died Jan 17, 1853, aged 36 y
- **James**
 - Wm., died Mar 25, 1875 in his 62 year and Susan, wife of Wm, died Mar 25, 1868 in her 55 yr ([Both stones](#)) (Contact Coleen Jones, copi50@yahoo.com)
 - Vincent, 1920-[blank] and Rosemary, 1924-1989
- **Kessler**, In loving memory of Susan Calahan, great-granddaughter of James and Lucy Taggart, interred within these historic grounds. May her soul add beauty and light to the far reaches of heaven, as did her life to the lives of ehr family.
- **Kimber**, Wife of A L, died Oct 29, 1849, aged 21 yrs 1 mo 18 ds
- **Kirkpatrick**, R., died Feb 28, 18881, aged 74 yrs 9 mos & 5 ds ([Whole stone](#))
- **Labaree**, Eliza, dau og J & H, died Oct 17, 1847, aged 25 yrs & 1 month
- **Loury**, Samuel, died Jan 6, 1890, aged 70 y 24 d ([Whole stone](#))
- **Lowry** (Contact Odean Dozier, dozier1974@digitalpath.net)
 - Andrew, died Oct 26, 183[6], aged 45 yrs ??m ??d
 - Andrew, Jan 14, 1822-Jan 16, 1893, Member of Co J 145TH Regt OVI ([Whole stone](#))
 - Betsey, wife of John & daughter of D & P (Thomas?) was born March 10, 1--9 [broken]
 - Blanche Edna, 1903-1978
 - Dad, Chatles T., 1931-1999
 - Little Gracie, dau of Minnie E., died J[une] 16, 1883, aged 1m 7d ([Whole stone](#))

- Infant Son of Andrew & Mary [no dates]
- James C., 1868-1938 and Alice J., 1868-1944
- John, died Nov 6, 1881, aged 74y 8m & 8d and, on same stone, Ann, died Sep 14, 1885, aged 83y 2m & 5d (Whole stone)
- Mary, wife of Sam^l, died Feb 2, 1850, aged 29 yrs 3 mo 16 ds (Whole stone)
- Mary E., wife of C T, died Mar 27, 1881, aged 23 ys 1m & 18 ds and, on same stone, Lorance, dau of C T & M E, died Feb 20, 1881 aged 1y 3m & 21d (Whole stone)
- Mary E., dau of R & L, died Mar 12, 1850, aged 4 ms 4 ds (Whole stone)
- **Luke**, Mary E., wife of W S, died Oct 14, 1883, aged 23 y 11 m 10 d
- **Macomer**
 - John A., Mar 2, 1855-Nov 15, 1914
 - Raney, July 10, 1870-July 25, 1939
 - W. E., CO E, 30TH OHIO INF
- **Maxwell**, Alice French, Nov 24, 1895-June 13, 1982
- **McCutchan**, Samuel, died Oct 26, 1850, aged 11 yrs 7 ms 12 ds
- **McMaster**
 - Laura E., Jan 14, 1912-Aug 27, 2003
 - Robert C., May 13, 1913-July 6, 1986
- **Meeker**, Father, Wickliff C., Nov 2, 1835-Nov 28, 1881
- **Mercer**
 - Dr. N. Z., died Feb 26, 1856, aged 53 yrs 11 mo 16 ds
 - W. Z., CO K, 145TH OHIO INF
- **Nout**, Kamphorng, April 1, 1916-March 18, 1982
- **Rhoads**, Joseph A., 1853-1939 and Martha A., 1850-1926
- **Saurers**, Donald Lee, 1931-1999
- **Simms**, Loueza, born in Frederick, MD, died June 20, 1889, aged 18 (or 78) ys
- **Slack**, Laura P., wife of Gilbert, died Jan 29, 1872, aged 36y 4m 26d; L. P., 1886-1941; and Gilbert, 1851-1916 (Whole stone)
- **Slain**
 - Died June 18, 1840, Nancy, wife of Elias, aged 54 yrs
 - Died Sept 11, 1846, Thomas, son of Elias & Nancy, aged 18 yrs 5 mo 18 ds
- **Slane**, Cornelius, son of C[?] & M[?], died Sept 1, 1855, aged 1 yr 9 mo 1 d
- **Smith**, B. F., died Feb 22, 1860, aged 57 yrs 5 mos 12 ds and Amanda, wife of B F, died Jun 2, 1894, aged 87 ys 2 ms 1 d (Whole stone)
- **Taggart**
 - E. G., 1836-1907 and Mary B., his wife, 1833-1917
 - Margaret, wife of John, died Feb 20, 1880, aged 66 yrs 2mo 18 ds and John, died Oct 30, 1869, aged 57 yrs 6 mo 2 ds (Whole stone)
- **Thomas**
 - Francis G., son of Cordelia L., died Nov 28, 1879, aged 19 ys 8 ms & 1 d (Whole stone)
 - Janna A., dau of U & S, died July 4, 1881, aged 19 ys & 8 ms (Whole stone)
 - Margaret J., dau of P & A, died Aug 8, 1877, aged 26 yrs 9 ms 8 ds (Whole stone)
 - Minnie E., dau of U & S, died Sep 16, 1871, aged 6 yrs 3 mo 23 ds (Whole stone)
 - Ural, Dec 5, 1830-May 2, 1908 and Susannah, wife, Feb 20, 1837-Feb 20, 1923
 - Ural, CO H, 149 OHIO INF
- **Thompson**
 - S. S., CO E, 175TH OHIO INF
 - Samuel, who departed this life A[ugs]t 30th, 1831 [broken fragment of whole stone]
- **Tilton**, Mary S., daughter of F & M, died July 22, 1847, aged 1 yr 2 m 2 ds
- **Tuller**, Martha E., wife of A D & dau of B F & A Smith, died Jan 17, 1869, aged 23 yrs 9 mos 20ds (Whole stone)
- **Vigar**
 - Earl G., 1886-1907
 - Esther G., 1895-1918

- George B., 1849-1914 and Marietta P., 1857-1896
- Watson, Julia A., daug of C C & S L, died May 28, 1854, aged 4 ys 9 ms & 17 ds
- Wilson, Joseph L., died Aug 7, 1834, Æ 24 years 7 m 29 d
- **Unknown**
 - Sarah J., died June 20, 1900, aged 59 ys 9 ms 27 ds and Josephine A., died Aug 14, 1880, aged 29 ys 4 mo 28 ds (No surname on either side of stone)
 - Illegible
 - Broken & illegible
 - Illegible, probably a Holbrook
 - Little Franky (no surname or dates)
 - Illegible (weathered)
 - Isaac O. (no surname or dates)
 - Broken, 61 yrs 1 mo 13 ds
 - Broken & illegible
 - Illegible

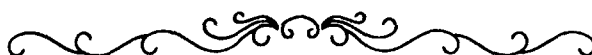

[Delaware County, Ohio Cemetery Photos](#)
[Fairfield County Cemetery Photos](#)
[Franklin County, Ohio Cemetery Photos, &c.](#)
[Licking County Cemetery Photos](#)
[Madison County Cemetery Photos](#)
[Pickaway County Cemetery Photos](#)
[Union County, Ohio Cemetery Photos](#)



This page is owned & maintained by
[Leona L. Gustafson](#)

[Gustafson - Wichmann Ancestry](#)

NOTICE: These electronic photographs may NOT be reproduced in any format for profit or presentation by any organizations or persons. Persons or organizations desiring to use this material, must obtain the written consent of the webmaster .

Liberty Cemetery Inventory

Read Oct. 10, 1947—Source 4

Read August 22–30, 1995 by Judith K. Brozek & Jeffrey D. Hamilton

When reading this cemetery in 1995, we listed the graves according to the rows and numbering depicted on the WPA map from the late 1930's. In some cases, the WPA row and grave numbers given for known veterans did not match today's location of markers. When this occurred, we listed the markers as they are positioned today, sometimes noting their prior position.

Based on the WPA veterans list, and the 1947 and 1995 readings, there are 507–511 known burials in Liberty Cemetery. Because the records for this cemetery have been lost, there is no way to determine whether or not all of the 917 gravesites and four family lots shown on the WPA map are occupied. It can only be assumed that the many areas without tombstones are occupied. It seems that this cemetery should be more than 56% full based on its central location in the community and its relationship to Liberty Church.

The cemetery is the most visible in Liberty Township; however, there are many broken or toppled stones as well as many about to fall in 1995. Grass has grown over many of the stones that have fallen. Most of these stones are still legible. In general, the stones are in need of maintenance. In some places, bushes and poison ivy are growing around the tombstones. The grass is cut and fence maintained by the Liberty Trustees.

—J. Brozek

The inventory follows the WPA map and begins at the northwest corner of the cemetery with:

ROW 1 North to South

2–3 KNOWN BURIALS

(WPA shows a veteran in Row 1, Grave 1—no marker in 1995.)

Open space/no markers

Stone broken off at ground

THOMAS, John H. (Civil War) (Stone gone—1995. Could above broken off stone be John Thomas'?)

SIMMS, Loueza Born in Frederick, MD. d. June 20, 1889 aged 18y
(In the 1947 reading, this stone was in Row 2 between Schiedts and Rhoads.)

Rest of row open/without markers

LIBERTY CEMETERY

11

NOTE: Local legend states that John Flanigan Cellar went off to the War of 1812 and upon his return found his girlfriend Lydia Sackett on her deathbed. Upon her death, John received permission from her father to bury her in a grove of oak trees on the land he would one day inherit. If Lydia died in 1814 as reported, her burial was not the first in this location: Capt. Joab Norton was interred here in 1813.* (Further reserach must be done to verify the date of Lydia Sackett's death.)

In 1816, John's father Thomas was buried in this same grove of tall oaks, marking the beginning of a family burying ground. The next known burial was another relative (Nancy Flanagan) in 1820, the same year John and his brother George received a contract of \$70 to build Liberty Presbyterian Church. Thirty-five years later, John deeded to the trustees of Liberty Church the three acres upon which the church, cemetery and school house stood.

Liberty Cemetery, sometimes called "Old Liberty," is the most visible of the township's pioneer burying grounds because of its location on the corner of S. R. 315 and Home Road. It is the largest in the Olentangy River Valley, its size attributable to its association with Liberty Church. Liberty Cemetery is the final resting place of more veterans of war than any other cemetery in the township.

*Although the 1880 History of Delaware County states that Capt. Joab Norton (one of the organizers of a local rifle company that fought in the War of 1812) "...was buried with Masonic honors in the first cemetery laid out in the city (Delaware)," Capt. Norton's tombstone is in Liberty Cemetery. His wife Lucy is buried beside him. When Norton arrived in 1807, his land was in Liberty Township; but in 1816, three years after his death, that portion of Liberty was set off in creating Orange Township. According to the 1880 History of Delaware County, the company of riflemen Norton led was "...composed (in 1809) mostly of Liberty men, and consisted of some forty officers and privates." It is probable that John Flanigan Cellar was in this company that was ordered to defend the boundary line at Norton, between Delaware and Marion commencing June, 1812. Later, the company built a blockhouse at Sandusky. When Norton was not given command of this blockhouse, he and his company were retired in August of 1812.

Property Description: 19-3-1-13

Location: In Old Liberty Churchyard at NW corner of State Route 315 and County Road 124 (Home Road)—10 feet west of 315 and 25 feet north of Home Road in Liberty Churchyard.

☞ Appears on USGS Topo Map.

Size: 1 acre (Source 1)
Approx. 917 gravesites (including 54 veterans) in 25 rows (Source 1—1930's)

Status: Cemetery is enclosed with 3-board fencing. The grounds are maintained by Liberty Township Trustees. Many broken and leaning stones. Many broken stones have been removed from the gravesites and leaned against the south wall of Old Liberty Church.

First Known

Burial: 1813—Capt. Joab Norton
1812–1814—Lydia Sackett

Last Known

Burial: 1991—Eugene K. Taggart

Inventory: See following pages.

Sources: 1, 2, 3, 4, 7, 10
Also: "Cemetery Notes" by Catherine and Wm. Cross with Ruby Pugh (Located DCHS)

ROW 4 S to N**19 KNOWN BURIALS**

Single monument:

COVELL, George W. 1914-1984
COVELL, Ruth V. 1921-19—

NOUT, Kamphorng b. April 1, 1916 d. Mar. 18, 1982

MAXWELL, Alice French b. Nov. 24, 1895 d. June 13, 1982

Single monument:

JAMES, Rosemary 1924-1989
JAMES, Vincent 1920—

McMASTER, Robert C. b. May 13, 1913 d. July 6, 1986
CALOVINI, G.

Single monument:

MACOMBER, Naum 1811-1903 "FATHER &
MACOMBER, Mary M. 1816-1894 MOTHER"

MACOMBER, W. E. Co. E 30th Ohio Inf. (government stone)

THOMAS, Francis G., son of Cordelia E. Thomas d. Nov. 28, 1878 ae 8y 8m 1d
(Above stone has toppled) (Is probably an extension of Thomas Lot in Row 5.)

Single monument:

CASE, Almira d. Sept. 29, 1909 aged 83y 21d
CASE, Norman d. Jan. 29, 1884 aged 59y 3m 17d

Single monument (old base/new top):

BLANEY, Carlton G. "Our Father d. Jan. 6, 1874 aged 63y 4m 12d
BLANEY, his wife Amelia E. & Mother" d. Aug. 29, 1891 aged 73y 2m 22d
BLANEY, Henry O. Co. K 121 Reg. O.V.I. died at Nashville, Tenn. Jan. 6, 1864 aged 18y 4m 15d
BLANEY, Nancy H. d. May 1, 1880 aged 17y 7m 20d

BLANEY, Thomas W. 1880-1886

Single monument:

BLANEY, S. C. 1848-1915
BLANEY, his wife Mary L. 1855-1894

ROW 5 N to S**9 KNOWN BURIALS**

Single monument:

CASE, Ralph b. Mar. 21, 1834 d. Aug. 11, 1900
CASE, his wife Miranda b. Sept. 28, 1838 d. July 2, 1906

CASE, William b. Jan. 16, 1830 d. Jan. 29, 1906 ae 76y 13d

Footstone leaning against giant, old oak tree

_____, Lorane, wife (Stone is broken. Only top corner remains and is on ground.)

LOWRY, Little Gracie, dau. of Minnie E. Lowry d. June 16, 1888 ae 1m

ROW 2 South to North**9 KNOWN BURIALS PLUS REMAINS FROM**
"UNNAMED" CEMETERY

marker* These 3 old sandstone markers were relocated from "Unnamed Cemetery" in The Retreat
marker Subdivision—1974. *The stone furthest south reads "John Case died _____. The
marker other two are illegible. (See "Unnamed Cemetery" for more information.)

Open space/no markers

Single monument:

CHAMBERS, Cyrus	1833–1907	(GAR flag holder)
CHAMBERS, Nancy Jane	1839–1920	
CHAMBERS, James E.	1862–1863	
CHAMBERS, Wilson E.	1867–1868	their sons

Single monument:

SHEETS, Frederick E.	1884–1893	sons of J. E. & M. A. Sheets
SHEETS, Charles L.	1887–1904	"Gone but not forgotten"

Also footstones:

Frederick
Charles

SCHIEDTS, Emma C., dau. of J. E. & M.

d. Aug. 4, 1877

aged 11y 6m 12d

Single monument:

RHOADS, Joseph A.	1853–1939
RHOADS, Martha A.	1850–1926

ROW 3 N to S**11 KNOWN BURIALS PLUS REMAINS FROM**
"UNNAMED" CEMETERY

VIGAR, Esther G. 1895–1918

Single monument:

VIGAR, George B.	1849–1914
VIGAR, Marietta R.	1857–1886

VIGAR, Earl G. 1886–1907

Single monument:

BARD, Martha O.	(b. June 18, 1879?)	d. Mar. 1, 1878 (or 79)	in 62nd year
BARD, William B.	(b. May 18, 1803)	d. Feb. 29, 1880	in his 77th year
BARD, Isaac	(b. Sept. 22, 1808)	d. June 6, 1876	in his 68th year

This is where Charles and Frederick Sheets' footstones are, followed by open space/no markers.

MACOMBER, Raney b. July 10, 1870

d. July 25, 1939

MACOMBER, John A.

b. Mar. 2, 1855

d. Nov. 15, 1914

Open space/no markers

Single monument:

GOODRICH, Fred C.	1878–1952
GOODRICH, Alice A.	1890–19__

Open space/no markers

marker These 4 old sandstone markers were relocated from "Unnamed Cemetery" in The Retreat
marker Subdivision—1974. *The stone furthest south is flat on the ground and reads "Mrs. Lydia
marker Case, wife of Alexr Dixon, died Nov. 2, 1814 in the 45th year of her age." The other 3
marker* stones are illegible.

ROW 5 — N to S — continued

In THOMAS LOT marked with "T" at each corner:

THOMAS, Minnie E., dau. of U. & S.

d. Sept. 16, 1871

ae 6y 3m 23d

THOMAS, Janna A., dau. of U. & S.

d. July 4, 1881

ae 19y 6m

Single stone: (Also a government military stone for Ural Thomas)

THOMAS, Ural

b. Dec. 25, 1830

d. May 2, 1908

THOMAS, wife Susannah

b. Feb. 20, 1837

d. Feb. 20, 1925

Open space through rest of row to S. fence line

ROW 6 — S to N**18 KNOWN BURIALS**

EVANS, Lieut. G. M. Co. A 52nd U? Line

Large expanse of open space

Single monument with 8 names:

FINLEY, James

d. Aug. 19, 1871

aged 61y 9m 12d

FINLEY, Martha, wife of James

d. ____ 9, 184_

aged 38?y 1m

FINLEY, Margaret A.

d. Dec. 22, 1893

aged 57y 6m 21d

Children of Jas. & Martha Finley:

FINLEY, Jane I.

d. Aug. 5, 188?

aged 3m 25d

FINLEY, John W.

d. Aug. 25, 184_

aged 6m 2d

FINLEY, Infant son

d. Oct. 10, 1848

aged 19d

FINLEY, Elizabeth A.

d. May? 18, 1863

aged 24y 5m 24d

FINLEY, Calvin E.

d. July 25, 1862

aged 21y 7?m 12d

CASE, Ralph

d. Jan. 17, 1863

aged 78y 6m 11d

CASE, wife Mary

d. Feb. 28, 1835

aged 30y 8m

(Above stone broken and flat on ground)

HARD, Cynthia (Case), wife of A. B.

d. Sept. 1, 1868

aged 45y 4m 10d

CASE, Emily

b. Sept. 7, 1829

d. Feb. 10, 1897

CRAWFORD, Anna, dau. of E. M. & M. M. Crawford

d. Aug. 22, 1884

ae 1y

ELSBREE, Gustavus

d. June 29, 1877

aged 49y 11m 5d

CASE, Mary

b. Mar. 21, 1834

d. Apr. 14, 1899

CRAWFORD, Eddie F.

1885-1913

CRAWFORD, Emory M.

1855-1923

ROW 7 — N to S**17-18 KNOWN BURIALS**

BUZAS, Joseph Paul, Jr.

b. Oct. 9, 1942

d. Dec. 8, 1989

HEWITT, Ralph A., Jr.

b. June 4, 1941

d. Mar. 3, 1983

(Above 2 graves are next to church between Rows 6 & 7)

EVANS, Rollin N.

1877-1944

EVANS, Melissa J., wife of Thos. J. 1837-1910

MOTHER

EVANS, Lulu W.

1875-1969

MERCER, W. Z.

Co. K

145 Ohio Inf. (government stone)

HOWARD, Naomi, wife of I.N.

1853-1906

ROW 10 — S to N — continued

LOWRY, John, son of A.? S.? & M. (Stone is broken and flat on ground. The top portion with name is missing.)	d. Sept. 2, 1852	aged 4y 11m 9d
LOWRY, Mary, wife of Samuel	d. Feb. 2, 1850	aged 29y 3m 16d
THOMAS, Margaret J., dau. of P. & A.	d. Aug. 8, 1877	ae 26y 9m 8d
Single monument:		
LOWRY, Mary E., wife of C. T.	d. Mar. 27, 1881	ae 25y 1m 18d
LOWRY, Florence, dau. of C. T.	d. Feb. 20, 1881	ae 1y 3m 20d
THOMAS, Infant dau. of P. & A. (gone)	d. Oct. 12, 1853	
LOWRY, Andrew "Though greedy worms destroy my skin And gnaw my wasting flesh When God shall build my bones again He'll clothe them afresh." (Stone is broken and flat on ground)	d. Oct. 26, 1836 (38?) (died of milk sickness)	ae 45y 2m 24d
LOWRY, Infant son of Andrew & Mary (no dates) (This stone has been moved north in same row. It is now between Robert/Margaret and Betsey Lowry.)		
LOWRY, Mary, wife of Andrew "All leveled by the hand of death, Lie sleeping in the tomb; Till God in judgment call them forth To meet their final doom." (Stone is broken and flat on ground)	d. Oct. 31, 1838 (died of milk sickness)	ae 48y 5m 8d
Single stone (flat on ground; half-buried):		
LOWRY, Robert, son of J. & B.	d. July 12, 1845	ae 3m 20d
LOWRY, Margaret, dau. of J. & B.	d. Aug. 27, 1845	ae 3y 10m 8d
LOWRY, Mary J., dau. of John & Betsey (gone)	d. Dec. 9, 1834	ae 13y 8m 21d
LOWRY, Betsey, wife of John & dau. of D. & P. Thomas	b. Mar. 15, 1819 d. June 21, 1854	
Single monument:		
LOWRY, John	d. Nov. 6, 1881	aged 74y 8m 8d
LOWRY, Ann	d. Sept. 14, 1885	aged 82y 2m 5d
Single monument:		
CASE, Seth W.	d. May 1, 1866	aged 54y 1m 21d
CASE, wife Mary T.	d. Apr. 5, 1906	aged 89y 10m 5d
CASE, Mary J.	d. Jan. 16, 1853	aged 14y 22d
CASE, James B.	d. Sept. 22, 1858	aged 13y 9m 5d
CASE, Eliza J.	d. Aug. 30, 1866	aged 9y 9m 12d
(Last 3: "Children of S. W. & M. T. Case")		
2 footstones		
LABAREE, Eliza, dau. of J. & H.	d. Oct. 17, 1847	aged 25y 1m
1 footstone		
CASE, Watson b. Hartford, Co., Conn., June 8, 1781 (Above stone is broken and flat on ground)	d. Aug. 10, 1853	aged 72y 2m 2d
CASE, his wife Sylvia b. Hartford Co., Conn. July 27, 1780	d. July 18, 1855	aged 74y 11m 21d
COLVIN, Susan (Almost illegible—1995)	d. Aug. 25, 1875	aged 59y
CASE, Susanna Taylor, wife of Luther Case	d. Nov. 25, 1875	ae 84 yrs
(These last two stones alike—were they mother & daughter? Both stones are almost illegible in 1995.)		
LOWRY, Charles T. "DAD" 1850–1897 Old, upright stone in ground near church—illegible	(In "Lowry Lot" marked by four "L" cornerstones.)	

ROW 8 S to N — continued

CASE, Albert	d. Apr. 17, 1888	aged 63y 17d
CASE, wife Mary A.	d. Nov. 23, 1861	ae 28y 9m 11d
CASE, wife Sarah (Stone flat on ground—1995)	d. Dec. 31, 1865	ae 30y 8m 16d
CASE, Cornelia F., dau. of A. & M. A.	d. Sept. 15, 1853?	ae 1y 10m 12d
CASE, Laura E., dau. of A. & M. A.	d. Nov. 4?, 1855	

(Above two stones are almost illegible—1995)

ROW 9 N to S**20-21 KNOWN BURIALS**

BARKER, Iris Lowry	1899-19—	} In "Lowry Lot" marked by four "L" cornerstones.
LOWRY, Blanche Edna	1903-1978	
Single monument:		
LOWRY, James C..	1868-1938	
LOWRY, Alice J.	1868-1944	

Single stone:

ANDERSON, Lorenzo D.	1837-1911	Co. I	82	OVI	(GAR flag holder)
ANDERSON, Jane M.	1836-1916				

ANDERSON, Samuel A.	b. Philadelphia, Pa., Nov. 7, 1812	d. Mar. 25, 1874	in his 62nd year
LOWRY, Ethel, dau. of J.C. & A.J.		d. Oct. 1, 1881?	aged _____

Single monument:

KIRKPATRICK, R.	d. Feb. 26, 1881	aged 74y 9m 5d
KIRKPATRICK, his wife Esther	d. Feb. 8, 1895	aged 89y 9m 10d
KIRKPATRICK, Thomas, son of R. & E.	d. Dec. 21, 1854	ae 14y 1m 1d

CUNNINGHAM, Marion Kirkpatrick Pennell	b. Oct. 1838	d. Sept. 1925
(Above marker is at the base of the Kirkpatrick monument.)		

KIRKPATRICK, Robert M., son of R. & E.	d. Dec. 14, 1848?	ae 5y 6m 7d?
(Above stone is illegible in 1995)		

TILTON, Mary S., dau. of E. & M.	d. July 22, 1847	aged 1y 2m 2d
ELSBREE, Eliza C. (or G.), dau. of C. P. & M.	d. June 8, 1862	ae 18y 11m 21d
(Above stone is broken and flat on ground)		

ELSBREE, Destamona (sic)	d. Oct. 16, 1872	aged 42 (or 12)y 8m
ELSBREE, Collins P.	d. Feb. 16, 1880	aged 79y 10m
WILSON, Joseph L.	d. Aug. 7, 1834	ae 24y 7m 27d

(Top with name is now broken off stone—1995)

LOWRY, Samuel	FATHER & MOTHER	d. Jan. 6, 1890	aged 70y 24d
(no further inscription—a small stone nearby may mark wife's grave)			

Here is a rough-cut slab of limestone that is flat on ground—no inscription.

ROW 10 S to N**31 KNOWN BURIALS**

MEEKER, Wickliff C.	b. Nov. 2, 1835	d. Nov. 28, 1884	
(When cemetery was inventoried in 1947, this stone was in stack of stones along south wall of old Liberty Church.)			
LOWRY, Joseph C. (or G.), son of J. & E.		d. Nov. 4, 1854	ae 10y 2m 25d
(Above stone is gone—1995)			
LOWRY, Andrew J.	b. Jan. 14, 1822	d. Jan. 6, 1893	Co. A? 145 Reg. OVI
LOWRY, P. Fiety (sic), dau. of S. & E.		d. Aug. 29, 1858	ae 1y 5m 6d
(Stone is broken and leaning against another)			

ROW 12 S to N**26 KNOWN BURIALS**

HARDEN, William d. Nov. 14, 1863 aged 48y 8m 27d

BROWN, Mary b. Aug. 7, 1833 d. Sept. 26, 1882
(Above stone is broken, on ground and illegible in 1995—"MOTHER" stone is nearby.)

KNAPP, Elizabeth G b. Sept. 12, 1916 d. Sept. 11, 1988
KNAPP, Mila Griswold b. July 6, 1874 d. May 5, 1957
KNAPP, Harlan P. b. Oct. 26, 1866 d. May 24, 1956

Single monument:

KNAPP, Lucy E. Cellar, wife of Wilson S. Knapp 1837-1902 (also footstone: L.E.K.)
KNAPP, Wilson S. (GAR flag holder) d. May 20, 1885 aged 49 yrs
KNAPP, Mary, dau. of W. S. & L. E. (also small stone on ground-1995) aged 15 yrs

DUNLAP, Joseph d. June 23, 1820 aged 35 yrs
(Above is weathered, partially buried stone flat on ground)

(MERRILL, Albert H.—is buried here. His stone has been moved to Row 13.)

CELLAR, Samuel Thomas d. Oct. 25, 1863 aged 24y 9m
CELLAR, Sarah Wilson, dau. of John F. & Lucy W. 1833-1902
CELLAR, Elizabeth Dunlap, his wife d. Aug. 20, 1820 ae 29 yrs
CELLAR, John F. d. Oct. 7, 1875 aged 87y 7m 6d

CELLAR, Infant children of John F. & Lucy: (This stone is gone-1995)
James Hogue d. 1834
Joseph Axtell d. 1846
Jane VanDeman d. 1845

CELLAR, Lucy Wilson, wife of John F. d. June 2, 1847 aged 39 yrs
(Broken stone; flat on ground)

Toppled stone in bush

McKINNIE, John Pvt. 3CL 8 Co 4BN PA MIL Rev. War 1741-1827
(Above marker relates to John McKinnie buried in Row 11, Grave 22.)

Single monument:

CELLAR, Mary W. 1876-1920
CELLAR, John E. 1880-1926

Single monument as well as individual stones:

GOODING, James Stanley 1859-1930
GOODING, Esther his wife 1866-1912
GOODING, Jamie A. 1895-1915
GOODING, Josephine 1897-1916
GOODING, Robert K. 1910-1939

} In "Gooding Lot" marked with
"T," "GT," & "G" cornerstones.

ROW 11 N to S**30 KNOWN BURIALS**

DIXON, William A.	1866-1953	}	"Dixon Lot" marked with "D" cornerstones.
DIXON, Phebe L.	1848-1937		
DIXON, James F.	1872-1916		
DIXON, Bertha E.	1881-1963		
DIXON, Infant Rebecca	1913		
DIXON, Marcella	June 30, 1915—Feb. 7, 1990		
Single monument:			
PINNEY, Grace	1885-1948		
PINNEY, Clarence	1884-1961		
Single monument:			
McKINNIE, Josiah	1831-1870	(GAR flag holder)	
McKINNIE, Mary J. his wife	1833-1917		
McKINNIE, Frankie, son of J. & M. J.		d. Aug. 17, 1863	ae 4 weeks
(There is also a single, old stone for "Franky" with above information. It is leaning against Wm. McKinnie's obelisk.)			
McKINNIE, Wm. Co. F? 96 Reg OVI	d. at Nicholasville, Ky. Nov. 16, 1862		ae 25y 1m 20d
(Large obelisk—grave has GAR flag holder)			
McKINNIE, James R., son of John & Eliza		d. Aug. 17, 1854	ae 21y 9m 24d
Single monument:			
McKINNIE, John		d. Aug. 22, 1858	ae 63y 9m 27d
McKINNIE, wife Eliza		d. Feb. 23, 1882	ae 81y 10m 29d
McKINNIE, Margaret, wife of Josiah		d. June 8, 1853	ae 82y 4m 6d
(Above stone is broken and on ground—1995)			
McKINNIE, Josiah		d. Mar. 22, 1849	ae 81y 9m 24d
McKINNIE, John		d. Oct. 7, 1827	aged 86 yrs
(His Rev. War military stone is due east)			
Single monument:			
JOSLIN, Jonas	FATHER &	d. Jan. 13, 1886	aged 78y 10m 19d
JOSLIN, Lucy	MOTHER	d. Feb. 14, 1886	aged 78y 5m 18d
GOODRICH, Corey M., dau. of H. L. & E. R.		d. Sept. 25, 1865	ae 7m 25d
ARRISON, Isabella, widow of Jephtha		d. Sept. 25, 1841	in 71st year
ARRISON, Jephtha		d. Aug. 11, 1827	ae 67y 1m 6d
ARRISON, Infant son of Samuel R. & Fanny	b. & d. July 1828		(Stone upside down/flat)
ARRISON, Hellen, dau. of Samuel R. & Fanny		d. Aug. 28, 1842	aged 1 yr
Single monument:			
THOMAS, Philo	FATHER (GAR)	d. Oct. 20, 1890	aged 70y 4m 27d
THOMAS, his wife Ann	1824-1905		
SEIGFREID, Mary E., dau. of L. & C.		d. May 15, 1851	ae 1y 3m 3d
(Above stone is broken and flat on ground)			
SAGER, Aura F., dau. of J. E. & B. (Stone gone—1995)		d. Sept. 21, 1863	ae 1y 1m 4d
SAGER, Mary Ann, wife of Wm.		d. July 22, 1867	aged 62y 15d

ROW 14 S to N**34-35 KNOWN BURIALS**

GILLIS, Romeo 1852-19—
 GILLIS, Georgiana 1862-1934
 GILLIS, Frank R. 1904-1975
 GILLIS, J. J. Co. I 82nd Ohio Inf. (government stone)
 _____, Ira, son of _____ (Stone is mostly buried in 1995)

Single stone:

GILLIS, Emeline 1814-1854
 GILLIS, Jeremiah 1803-1877

Here is an early, large, ornate sandstone marker badly weathered and illegible.

GILLIS, James Hoge, infant son of Jeremiah & Laura Gillis d. Oct. 25, 1833
 (Above stone almost illegible in 1995)

CARPENTER, Hannah, wife of Jno. (On ground—1995)	d. June 20, 1853	aged 77y 4m 1d
CARPENTER, Nathan, son of John & Hannah (Above stone is illegible in 1995)	d. Sept. 22, 1823	ae 13y 3m 18d
CARPENTER, Martha R., dau. of John & Hannah (Above stone almost illegible in 1995)	d. Sept. 29, 1823	ae 11y 9m
GILLIES, Martha M., dau. of James & Jane b. Jan. 27, 1804	d. Jan. 3, 1844 (14?)	
GILLIES, Eliza, dau. of James & Jane b. Jan. 22, 1809	d. Oct. 5, 1839	
GILLIES, John, son of James & Jane	d. Aug. 19, 1824	ae 24y
GILLIES, Mary, dau. of James & Jane	d. Dec. 19, 1822	aged 4 years
GILLIES, Thos. C.	d. Jan. 6, 1879	aged 80y 11m 5d
GILLIES, John W., son of T. C. & M. (On ground—1995)	d. Oct. 16, 1848	ae 7y 5m
GILLIES, James (On ground—1995)	d. Jan. 14, 1844	aged 70y 7m 13d
GILLIES, wife Jane	d. Oct. 9, 1844	ae 71y 4m 8d
GILLIES, Sarah E. b. Oct. 18, 1801	d. Jan. 3, 1884	
R. M. C. "FATHER"		

Single monument:

HARDIN, Solomon b. Dec. 11, 1818	d. Feb. 22, 1891	
HARDIN, Christiana Harter b. Nov. 8, 1827	d. Dec. 6, 1887	
HARTER, Clara E. b. Oct. 31, 1829	d. Nov. 30, 1887	(Stone broken—1995)
HARTER, E.		

(Names on above two stones also appear on the following family monument.)

Single monument:

HARTER, Andrew	d. May 19, 1879	ae 84y 4m 8d
HARTER, wife Laura P.	d. June 5, 1866	aged 61y 3m 28d
HARTER, Elmora, dau. of A. & J.	d. Apr. 20, 1856	aged 2y 9m 10d
HARTER, Clara E.	d. Nov. 30, 1887	

HARTER, L.P.

HARTER, Florence Wilson 1861-1900

Single monument:

HARTER, Charles E. 1865-1946
 HARTER, Rhoda M. 1872-1946

FISHER, Miss Elizabeth d. Sept. 3, 1844 in 72nd year

MERRILL, Albert H. d. Oct. 25, 1863 aged 35 yrs
(Above stone is broken & leaning against Elizabeth Fisher. It should be in Row 12 G-10.)

Single small stone for Ernest Harter that reads HARTER, infant son of A.J. & L.A. June 7, 1881-Jan. 7, 1882
Single small stone for Harry Harter.

Single monument:

HARTER, Andrew J.	1836-1905	
HARTER, Lucy Ann, his wife	1843-1922	
HARTER, Harry S.	1869-1888	(Also a separate small stone mentioned above.)
HARTER, Ernest	1881-1882	(Also a separate small stone mentioned above.)

CELLAR, H. R.	1857-1910
CELLAR, Joseph McCoy	1830-1902
CELLAR, Mary C.	1868-1884
CELLAR, Eliza E.	1862-1872
CELLAR, Cynthia Scott	1833-1871

Single stone—upside down/flat on ground:

CELLAR, Margarette Alice, dau. of J. & E. C.	d. Sept. 28, 1846	ae 3y 10m
CELLAR, Sarah Frances, dau. of J. & E. C.	d. Sept. 26, 1846	ae 9y 8m

CELLAR, Baruch Holbrook, son of J. & E. C.	b. Sept. 27, 1832	d. Feb. 4, 1838	aged 5y 4m 7d
CELLAR, Martha Deademia	b. May 3, 1848	d. July 9, 1897	

"E.C.C." footstone

Single stone:

CELLAR, Joseph—this at top of stone with no dates, below is the following:

CELLAR, Evelyn Cornelia, his wife b. Aug. 12, 1808 d. Aug. 17, 1886

CELLAR, Sarah Flanagan, wife of Thomas d. July 18, 1823 aged 68 years
"As a neighbor, friend, relative, She was greatly beloved and having long lived a Christian life
She resigned her breath in hope of immortality."

CELLAR, Thomas d. Apr. 6, 1816 aged 75 years
"He was exemplary as a friend, and affectionate as a relative; and for many years fulfilled the
office of Ruling Elder in the Presbyterian Church with credit and usefulness."

CELLAR, Robert McCoy d. Mar. 5, 1861 aged 76y 3m 9d
"He was an intelligent working Christian and for many years filled the office of Ruling Elder
in the Presbyterian Church."

CELLAR, Julia P. H.,
wife of James & dau. of B. & D. Holbrook d. Sept. 15, 1839 aged 35 yrs

CELLAR, James b. Mar. 16, 1795 d. Feb. 22, 1863

CELLAR, E. R. b. Aug. 20, 1803 d. Sept. 25, 1873 aged 70 yrs

Single stone:

TONE, Lafayette	1824-1908	
TONE, his wife Sarah M.	1834-1915	(Sarah and Elizabeth were twin sisters.)
CELLAR, Elizabeth D.	1834-1915	

GOODING, Ebenezer d. Jan. 12, 1863 ae 68y 2m 3d

ROW 14 S to N — continued

Single monument:

GOODING, Fred M. 1866–1948
 GOODING, Mary E. 1874–1959

Single monument:

TAGGART, James E. 1866–1965
 TAGGART, Lucy Knapp 1872–1962

ROW 15 N to S**30 KNOWN BURIALS**

TAGGART, Helen Y. 1905–
 TAGGART, Eugene K. 1900–1991

CELLAR, Corpl. George C. Co. F 96th Ohio Inf. (government stone)
 CELLAR, Eunice A., wife of M. H. d. Jan. 5, 1872 aged 38y 10m 1d
 CELLAR, Bessie d. Dec. 24, 1896 aged 35 years
 _____, Our Darling Mary (child's grave—stone is on ground and half-buried.)

CELLAR, Sarah A. b. Dec. 27, 1840 d. May 3, 1911 (These 2 stones are
 CELLAR, Eliza C. b. June 1, 1868 d. Feb. 26, 1893 gone—1995)

Here is a granite marker with the names "Solomon" and "Christina" (refer to HARTER in Row 14).

CELLAR, Robert McCoy b. Oct. 3, 1834 d. Mar. 23, 1881 (Civil War holder)

Single obelisk monument:

CELLAR, Mary, wife of G. C. d. Nov. 18, 1874 aged 32y 11m 4d
 CELLAR, Infant son of G. C. & M. d. 1874
 CELLAR, Infant dau. of G. C. & M. d. 1868

CELLAR, Sarah J. 1833–1911

Single monument:

CELLAR, George d. Feb. 23, 1860 in 69th year
 CELLAR, Rachel, wife of G. d. Feb. 12, 1887 in 84th year
 CELLAR, Joseph A. Co. A 15 Reg. U.S.A. d. May 11, 1862 in his 23rd year
 wounded at Shiloh, Tenn. Apr. 7, died at Newport, Ky.

CELLAR, James H., son of T. & M. d. Oct. 4, 1823 aged 7 mos
 CELLAR, Margaret G. wife of Thomas d. Nov. 4, 1827 in 48th (38?) year
 (Above stone is broken and leaning against Tho's Cellar's stone.)

CELLAR, Tho's d. June 11, 1854 aged 70y 4m 23d
 CELLAR, Capt. Jno. Co. K 145 Ohio Inf. (government stone)

EATON, Stephen S. (Stone is on ground—half-buried) d. Aug. 28, 1845 aged 50 years
 EATON, wife Olive (Stone almost illegible—1995) d. Sept.. 30, 1879 aged 94 yrs

Single monument:

EATON, Charles E. b. June 9, 1862 d. Sept. 27, 1871
 EATON, Stephen L. b. Feb. 23, 1826 d. Mar. 10, 1878
 EATON, Mary b. May 28, 1830 d. Oct. 18, 1884
 EATON, H. J. E. b. Mar. 24, 1849 d. May 1, 1851
 EATON, C. (or G.?) E. b. Jan. 8, 1858 d. Mar. 1, 1859

ROW 15 — N to S — continued

Small "MOTHER" stone

COLFLESH, Desdemona	d. May 4, 1881	ae 80y 6m
Single stone:		
NORTON, Capt. Joab	d. July 17, 1813	ae 33y 6m 5d
NORTON, wife Lucy G.	d. Nov. 28, 1854	ae 75y 1m 16d
(Capt. Joab Norton is listed by WPA in Row 13, Grave40.)		

ROW 16 — S to N**26 KNOWN BURIALS**

McCOY, Robert	d. Aug. 20, 1827	ae 50y 7m 12d
ANDERSON, R. M. Co. I 82nd Ohio Inf. (government stone)		
McCULLOUGH, Margaret F.	d. Nov. 22, 1838	ae 19y 1m 19d
McCULLOUGH, Mary	d. May 11, 1837	in 37th year
McCULLOUGH, Mary Jane, dau. of John & M.	d. July 6, 1837	ae 3m 21d
LATHROP, Philander	d. Nov. 20, 1842	ae 66 yrs
MACOMBER, Matilda, wife of A. Macomber	d. Feb. 23, 1863	ae 36 yrs
(This marker is off its base stone.)		
HINKLE, Asenath, consort of Michael	d. Jan. 25, 1844	ae 46y
Single obelisk:		
ANDREWS, Albert B., son of G. (or C?) A. & E.	d. Dec. 8?, 1860	ae 2y
ANDREWS, Franklin A. son of G. (or C?) A. & E.	d. June 7, 1868	ae 2y 7m
ANDREWS, Edeth A., dau. of T. & R. (On ground—1995)	d. June 3, 1850	aged 24y 2d
ANDREWS, Lorenda P., wife of F. S. W.	d. Aug. 13, 1845	aged 25 years
Single monument:		
ANDREWS, Timothy	d. Dec. 14, 1880	aged 82 yrs
ANDREWS, wife Ruth B.	d. Feb. 8, 1866	aged ca. 65 years
MARKS, Sylvester T., son of Sheldon & Ann	d. Aug. 16, 1845	ae 13 yrs
MARKS, Wm. O., son of W. S. & A. J.	d. Mar. 24, 1866	ae 2y 10m 7d
Single stone:		
MARKS, Sheldon	FATHER & d. May 14, 1879	ae 86y 11m 10d
MARKS, his wife Ann Knight	MOTHER d. June 9, 1879	ae 79y 4m 19d
MARKS, Erastus B.	1825–1909	
MARKS, Florence,		
dau. of E. B. & L. E.	d. July 29, 1856	ae 2y 3m 2d
MARKS, Lucy, wife of E. B.	b. Sept. 21, 1833 d. Aug. 15, 1905	
Single monument: (Also "FATHER" and "MOTHER" stones in 1995)		
RUTHERFORD, Abram V.	b. Apr. 7, 1830 d. Mar. 27, 1895	
RUTHERFORD, Eliza J.	1830–1908	
RUTHERFORD, Henry	1853–1918	
Single monument:		
KILPATRICK, Walter M.	1874–1945	
KILPATRICK, Elizabeth S.	1878–1945	

ROW 17 N to S**17 KNOWN BURIALS**

KILPATRICK, Walter M. b. Nov. 27, 1874 d. Feb. 22, 1945 Pvt. 50 Iowa Inf.
 Footstone
 SHAW, Lucy A., wife of D. Shaw & dau. of J. R. & P. V. Youel d. Dec. 26, 1869 aged 20y 4m 23d
 WEAVER, Sgt. J. P. Co. I 82? Ohio Inf. (government marker)
 BRADLEY, Charles H., (This stone is on ground, mostly grown over—west of tree stump)
 son of Wm. & C. S. b. May 21, 1846 d. Jan. 13, 1849
 BRADLEY, Ira b. Oct. 14, 1783 d. Nov. 25, 1850
 (Above stone is out of line for this row. It is just south of the stump of the old maple tree.)
 L.W.C. footstone
 McCUTCHEN, Sgt. Allen Co. D 46th Ohio Inf. (government marker)
 YOUELL, James R. d. June 7, 1879 aged 62 y 3m 17d
 YOUELL, Ann Eliza, dau. of John & Nancy (rest of stone is too weathered to read)
 YOUELL, Nancy, wife of John d. Aug. 3, 1844 ae 58 yrs
 YOUEL, Francis E., son of J. R. & P. V. d. June 5, 1851 ae 10 mos
 YOUEL, James D., son of J. R. & P. V., d. Mar. 11, 1865 ae 17y 11m
 wounded Nashville, Tenn. Dec. 16, 1864, d. Jeffersonville, Ind. Hospital
 IRWIN, Ann J., dau. of J. & L. ? (Stone gone in 1995.) d. Apr. 17, 1849 ae 2y 6m 2d

Single monument:

CARPENTER, Nathan 1824–1855 (Son of Nathan Carpenter, Jr., grandson of Capt. Nathan Carpenter.)
 CARPENTER, wife Polly Andrus 1829–1893
 CARPENTER, their son Natie 1855–1861
 Natives of Worthington, O.

{ There are also two old stones that relate to the above monument:
 Nathan Carpenter d. Mar. 14, 1855 aged 30y 11m
 Natie d. Nov. 23, 1861 ae 6y __m __d }

“W.T.H.” footstone

McCULLOUGH, Nancy, dau. of John & M. d. Mar. 19, 1836 ae 7m 9d
 (Above stone is illegible in 1995.)
 FLANEGAN, Nancy, wife of James d. Nov. 20, 1820 ae 38 yrs
 “R.M.C.” footstone flat on ground.)

ROW 18 S to N**13 KNOWN BURIALS**

WILMOTH, Moses d. Aug. 25, 1851 aged 22y 10m
 2 footstones
 HARDEN, Edmund P., son of Isaac & Catherine d. Aug. 6, 1843 ae 26 yrs
 HARDEN, Isaac d. Apr. 11, 1827 aged 79 years
 HARDEN, Sary, consort of Isaac d. May 7, 1832 in 79th yr
 Single monument:
 HARDIN, John d. Jan. 26, 1851 ae 59y 7m 20d
 HARDIN, wife Sarah d. Jan. 5, 1879 ae 87y 1m 1d
 HARDIN, Isaac O., son of J. & S. d. Oct. 28, 1871 ae 49y 1m 28d
 HARDIN, Laura, dau. of J. & S. d. June 17, 1850 ae 17y 2m 15d
 CONWAY, Ebenezer d. July 22, 1845 aged 38y 9m
 CONWAY, Viola E., dau. of F. & E. d. Sept. 5, 1869 ae 9m 25d
 Little stone—no markings
 GREGG, Homer E., son of H. & S. E. d. Oct. 24, 1848 ae 1 (4?)y 10m
 (Above stone is flat on ground—1995)
 JAMES, wife Susan d. Mar. 25, 1868 in 56th year
 JAMES, William (Stone is flat on ground—1995) d. Mar. 15, 1873 in his 62nd year

Here is a new, raised grave marked only with a cross made of tree branches. No name.

GRAY, Mary C. 1859-1940
 GRAY, John P. 1853-1912
 GRAY, W.A. 1836-1911 (flag holder)

(The above 3 inscriptions are on 3 small stones, with 1 big stone marked "Gray" next to them.)

"W.J." footstone (Wm. James)

"G.C." footstone

Single stone:

IN MEMORY OF FATHER & MOTHER

CRUIKSHANK, George
 CRUIKSHANK, wife Elizabeth

d. July 17, 1853
 d. Nov. 29, 1868

aged 76 yrs
 ae 86 yrs

IN MEMORY OF CHILDREN OF G.H. & A.F.

CRUIKSHANK, Harriet J.
 CRUIKSHANK, George T.
 CRUIKSHANK, Freddie
 CRUIKSHANK, Peter
 CRUIKSHANK, Dora
 CRUIKSHANK, G. H.
 CRUIKSHANK, Augusta F.,

b. Apr. 4, 1821

d. Mar. 19, 1854
 d. Oct. 1, 1855
 d. Aug. 7, 1856
 d. Sept. 23, 1862
 d. July 8, 1866
 d. Jan. 10, 1902

aged 2y 10m 15d
 aged 11 mo
 aged 17 days
 aged 2 mos.
 aged 5m 4d

wife of G. H.

b. May 27, 1822

d. Dec. 25, 1899

CRUIKSHANK, Martha E., dau. of G.H. & A.F.

d. Apr. 9, 1873

ae 14y 4m 7d

(The above 10 inscriptions are on one big stone.)

Here are 3 separate stones: "FATHER," "MOTHER," & "GRANDMOTHER."

Single stone:

BARTHOLOMEW, Major
 BARTHOLOMEW, wife Roxy

b. Dec. 13, 1812

d. Oct. 29, 1874
 d. Sept. 1, 1892

ae 67y 10m 16d

(Major Bartholomew also has an old, single stone—it is flat on ground)

Single stone:

BARTHOLOMEW, Thomas C., son of Major & Roxana
 BARTHOLOMEW, Jasper, son of M. & R.

d. Sept. 10, 1848
 d. Feb. 1, 1871

ae 3y 7m 4d
 ae 23y 9m 5d

CASE, Emily J., wife of M. S.
 BARTHOLOMEW, Benjamin

d. Apr. 9, 1873
 d. July 14, 1857

ae 36y 7m 7d
 in his 81st year

Open space with no stones

BUELL, Lydia L., dau. of P.E. & Lucy
 BUELL, Lucy A., wife of P.E.
 BUELL, wife Mahala (Stone is gone—1995)
 BUELL, Philaster E.

d. Oct. 20, 1849
 d. Aug. 16, 1854
 d. Jan. 11, 1886
 d. Jan. 15, 1886

ae 22y 8m 19d
 ae 53y 10m 21d
 aged 59y 11m 12d
 aged 83y 4m 6d

Single monument:

CRUIKSHANK, William
 CRUIKSHANK, wife Cynthia M.
 CRUIKSHANK, Eugene D.
 CRUIKSHANK, Homer D.
 CRUIKSHANK, Elizabeth M.
 CRUIKSHANK, Edward P.
 CRUIKSHANK, George W.

b. June 2, 1816
 b. Nov. 30, 1818
 b. Oct. 25, 1846
 b. May 12, 1841
 b. Dec. 17, 1844
 b. Feb. 8, 1840
 b. Nov. 19, 1842

d. Jan. 15, 1904
 d. Nov. 12, 1891
 d. Nov. 12, 1863
 d. July 13, 1864
 d. Mar. 12, 1849
 d. Sept. 18, 1853
 d. Jan. 1865

(In addition to this large monument, there are also individual stones marked "Mother,"

"Elizabeth," "Edward," "Eugene," and "Homer." There is also an old stone for George W.)

ROW 19 — N to S — continued

“M.H.K.” footstone

Single stone:

KNAPP, S. W.	b. June 19, 1794	d. Nov. 26, 1859	
KNAPP, his wife Mary H.	b. Sept. 10, 1802	d. July 9, 1888	
KNAPP, Harlan P.	b. Mar. 27, 1839	d. Oct. 19, 1861—	Children of
KNAPP, Harriet B.	b. July 2, 1845	d. Oct. 27, 1861—	S. W. Knapp

“S.W.K.” footstone

JARVIS, Lieut. H. J. Co. 5 96th Ohio Inf. (government marker)

ROW 20 — S to N

24 KNOWN BURIALS

HYDE, Joseph		d. Aug. 12, 1873	aged 81y 11m 15d
HYDE, Lucretia Yokam, dau. of J. & H. Hyde		d. Jan. 26, 1870	ae 27y 5m
(Above stone is on ground and is half-buried.)			
HOLBROOK, Baruch	b. Feb. 11, 1769	d. July 27, 1841	aged 72 years
“For I know that my Redeemer liveth, and that He shall stand at the latter day upon the earth.”			
(Both verses from Job 19th, verses 25th and 26th)			
HOLBROOK, Deadamia Duguid,			
consort of Baruch	b. Feb. 19, 1778	d. Sept. 29, 1840	aged 62 years—
“And though after my skin worms destroy this body, yet in my flesh shall I see God.”			
HOLBROOK, Joseph Moyer,			
son of Baruch & Deadamia	b. Sept. 28, 1820	d. July 15, 1840	aged 19 years
HOLBROOK, Addison Dwight,			
son of Baruch & Deadamia	b. Mar. 3, 1815	d. Feb. 7, 1839	aged 24 years
HOLBROOK, Azel Hart,			
son of Baruch & Deadamia	b. Apr. 4, 1806	d. Sept. 17, 1839	aged 33 years
HYDE, Elizabeth Eunice, consort of Joseph Hyde & dau. of Baruch & Deadamia Holbrook			
	b. Apr. 16, 1800	d. June 5, 1840	in her 41st year
HOLBROOK, Electa Ann,			
dau. of Baruch & Deadamia	b. Dec. 6, 1810	d. Mar. 23, 1841	aged 31 yrs
COLFLESH, Jacob	b. Jan. 23, 1787	d. Aug. 9, 1877	aged 90y 7m
(Above born in Pa., emigrated to Ohio in 1837.)			
COLFLESH, Betsey, wife of James		d. June 1, 1876	ae 58y 1m 16d
COLFLESH, Jacob L., son of J. & E.		d. Dec. 18, 1847	ae 17y 10m 26d

Here are two base stones without upright stones.

DUTCHER, Infant dau. of Wm. J. & E.D.	b. Oct. 28, 1861	d. Nov. 20, 1861	
SIM, Maurice, son of J.A. & Emily M.D.		d. Aug. 9, 1885	ae 3y 7m 21d
DUCHER (sic), David L., son of John B. & Mary		d. June 4, 1850	ae 22y 7m 14d
Base stone here without upright stone.			
DUTCHER, John B.	(Stone is flat on ground—1995)	d. Oct. 15, 1867	aged 65y 11m 26d
DUTCHER, wife Mary	(Stone is flat on ground—1995)	d. July 7, 1883	aged 78y 7m 23d

Single monument:

CRUIKSHANK, David G.		d. June 8, 1869	aged 60y 9m 11d
CRUIKSHANK, Loren J.		d. Sept. 16, 1868	aged 10m 22d
CRUIKSHANK, Ervin B.			
Co. F 90 Reg. OVI—killed in action at Sabine Crossroad, La. Apr. 8, 1864			ae 23y 7m 10d
CRUIKSHANK, Eliza	1816–1891		
(Ervin B. also has an old small stone that is leaning against the large monument. According to WPA, Ervin B. is buried in Row 19, Grave 11.)			

Footstone

ROW 21 N to S**20 KNOWN BURIALS**

Here is large granite monument with "Cruikshank" on it, then the following individual markers:

CRUIKSHANK, Mary	1834-1910	(nee Worland)
CRUIKSHANK, Stephen L.	1835-1909	
CRUIKSHANK, Frank L.	1859-1895	
CRUIKSHANK, Irvin P.	1862-1864	
CRUIKSHANK, Charles J.	1857-1864	
CRUIKSHANK, May	1879	ae 23 days

4 footstones—no markings

Single stone (broken):

TAGGART, John	d. Oct. 30, 1869	aged 57y 6m 2d
TAGGART, wife Margaret	d. Feb. 20, 1880	aged 66y 2m 18 d

Single stone:

TAGGART, E. G.	1836-1907
TAGGART, his wife Mary	1833-1917

GOODING, Elizabeth, dau. of G. A. & E.	d. Oct. 22, 1853 (5?)	ae 11m 21d
--	-----------------------	------------

(Above stone is broken into 3 pieces and is leaning against Jacob L. Colflesh in Row 20.)

Single stone:

GOODING, George A.	b. Nov. 4, 1826	d. Mar. 19, 1900
GOODING, wife Elizabeth	b. Dec. 17, 1828	d. Dec. 1, 1910

COLFLESH, LuElla	d. Feb. 3, 1864	ae 3y 1m 18d
------------------	-----------------	--------------

(Above stone is leaning against George A. & Elizabeth Gooding's stone.)

COLFLESH, Martin, son of J. & E. (small, broken stone)	d. Aug. 19, 1853	aged 2y 6m 13d
--	------------------	----------------

Open space/no markers

"L.A.B." footstone

"M.M.B." footstone

SLANE, Cornelius, son of A. & M. A. S.	d. Sept. 1, 1855	ae 1y 9m 1d
SLANE, Infant son of A. & M. A. S.	d. Oct. 31, 1852	ae 26days
SLANE, Byron A., son of A. & M. A. S.	d. Mar. 7, 1849	ae 2y 2m 11d

(Above stone is gone; base is there—1995)

SLAIN, Thomas, son of Elias & Nancy	d. Sept. 1, 1846	ae 18y 5m 18d
SLAIN, Nancy, wife of Elias	d. June 13, 1840	ae 54 yrs

Open space/no markers to southern fenceline

ROW 22 S to N**24 KNOWN BURIALS**

HARDEN, E. O., son of R. & E.		d. July 5, 1881	ae 31y 6m 20d
HARDEN, Infant son of R. & E.			
HARDEN, _____, son of R. & E.		d. Oct. 26, 1863	aged 18y 5m
CASE, Miles	1832-1912		(fallen stone)
CASE, wife Hannah M.		d. Aug. 15, 1895	aged 96y 7m 3d
CASE, Titus		d. Jan. 31, 1860	aged 63 yrs
Single monument:			
ELSBREE, George Francis	b. Sept. 11, 1834	d. May 28, 1919	
ELSBREE, wife Caroline Case	b. Aug. 12, 1837	d. May 15, 1918	
BRISTOL, Annah, wife of Correl		d. Jan. 14, 1870	aged 54 yrs
BRISTOL, Phebe, dau. of C. & A.		d. Aug. 26, 1868	ae 9y 5d
THOMPSON, D. S.	Co. E 175th Ohio Inf. (government marker)		
Single monument:			
SMITH, Sarah J., dau. of B. F. & A. Smith		d. June 20, 1900	ae 59y 9m 27d
SMITH, Josephine A., dau. of B. F. & A. Smith		d. Aug. 14, 1880	ae 29y 4m 28d
TULLER, Martha E.,			
wife of A. D. Tuller and dau. of B. F. & A. Smith		d. Jan. 17, 1869	aged 23y 9m 20d
Single monument:			
SMITH, B. F.		d. Feb. 22, 1860	aged 50y 5m 12d
SMITH, wife Amanda		d. Jan. 21, 1894	aged 81y 2m 1d
"MOTHER" stone			
Single "GRAY" monument:			
West face:			
GRAY, Ebenezer S.	1840-1864 (see government stone below)		
GRAY, Oliver T.	1843-1863		
GRAY, Clarissa E.	1846-1867		
GRAY, Phebe J.	1848-1867		
GRAY, Margaret E.	1851-1896		
East face:			
GRAY, John P.	Aug. 19, 1811-Sept. 25, 1867		
GRAY, Eliza, his wife	July 17, 1815-Oct. 13, 1897		
GRAY, E.S.	Co. K 145th Ohio Inf. (government marker)		
Four small footstones in a row:	1. blank		
	2. J. T.		
	3. M. T.		
	4. blank		

ROW 23 N to S**9 KNOWN BURIALS**

Base stone without upright stone

CARPENTER, Mary 1824–1900
BROWN, Sarah Carpenter 1833–1901

Single monument:

SLACK, Gilbert 1851–1916
SLACK, Laura P., his wife d. Jan. 29, 1892 aged 36y 4m 26d
SLACK, L. P. 1886–1941

Large expanse of open space/no markers

Single monument:

HARDIN, Lewis E. b. Aug. 28, 1881 d. Apr. 25, 1883
HARDIN, Elizabeth J. b. Nov. 20, 1857 d. Sept. 22, 1893

HARDIN, William T. b. Dec. 2, 1882 d. May 18, 1883 (stone gone—1995)
(above are wife and children of W. E. Hardin)

ROW 24 S to N**2 KNOWN BURIALS**

Single monument:

ELSBREE, A. C. 1831–1920
ELSBREE, his wife Elizabeth 1830–1901 (Also “E.A.E.” marker)

Footstone

ROW 25 N to S**5 KNOWN BURIALS**

Large tree, then:

Footstone

CASE, Allen b. Mar. 10, 1855 d. Sept. 28, 1932
CASE, wife Hillie R. Goodrich d. Oct. 23, 1928 (wife of Allen Case)

Single, new monument:

GOODRICH, Emma F. 1857–1947
GOODRICH, Lawrence F. 1852–1920

“J.B.C.” footstone—flat on ground

CLOSSON, M. J. b. July 21, 1845 d. June 27, 1903 “MOTHER”